

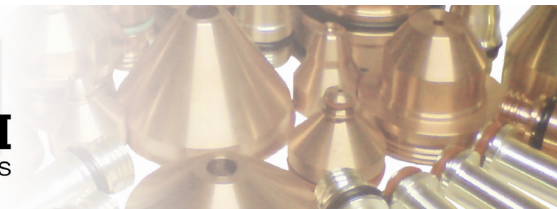

B & B[®]
BARTONI
CUTTING CONSUMABLES



EXHIBITION PROGRAMME 2012



JANUARY - JUNE

16.04. - 20.04.2012 / ENGLAND - BIRMINGHAM / MACH 2012

Sales manager: Petr Haupt, Jaroslava Poláková



17.04. - 21.04.2012 / CROATIA - ZAGREB / BIAM 2012

Sales manager: Karol Labaj, Jana Šmahlíková



09.05. - 12.05.2012 / ITALY - BOLOGNA / LAMIERA 2012

Sales manager: Petr Haupt, Jaroslava Poláková



15.05. - 18.05.2012 / SLOVENIA - CELJE / 5th WELDING & CUTTING FAIR 2012

Sales manager: Karol Labaj, Jiří Slezák



15.05. - 18.05.2012 / HUNGARY - BUDAPEST / MACH-TECH 2012

Sales manager: Jaroslava Poláková, Jana Šmahlíková



24.05. - 27.05.2012 / SLOVAK REPUBLIC - NITRA / EUROWELDING 2012

Sales manager: Karol Labaj, Jiří Slezák



04.06. - 07.06.2012 / CHINA - BEIJING / BEIJING ESSEN WELDING & CUTTING 2012

Sales manager: Petr Haupt, Jaroslava Poláková



JULY - DECEMBER

10.09. - 14.09.2012 / CZECH REPUBLIC - BRNO / WELDING 2012

Sales manager: Jiří Slezák, Karol Labaj



09.10. - 12.10.2012 / AUSTRIA - VIENNA / VIENNA-TEC 2012

Sales manager: Martin Švejda, Jaroslava Poláková



23.10. - 27.10.2012 / FINLAND - TAMPERE / NORDIC WELDING EXPO 2012

Sales manager: Karol Labaj, Jana Šmahlíková



23.10. - 27.10.2012 / GERMANY - HANNOVER / EUROBLECH 2012

Sales manager: Martin Švejda, Petr Haupt, Jaroslava Poláková



23.11. - 27.11.2012 / SWITZERLAND - BASEL / SWISSTECH 2012

Sales manager: Martin Švejda, Jaroslava Poláková





CEBORA[®]

CP 200 [®]	page	03
---------------------	------------	----

ESAB[®]/L-TEC[®]

PT-24 [®]	page	04
PT-600 [®]	page	05

HYPERTHERM[®]

Powermax1000 [®]	page	06
Powermax1250 [®]	page	07
Powermax1650 [®]	page	08
MAX200 [®]	page	09
HT2000 [®]	page	10
HT2000 [®] HySpeed	page	11
HPR HD3070 [®] upgrade	page	12
HPR HD4070 [®] upgrade	page	13
HPR130 [®]	page	14
HPR260 [®]	page	15
HPR130XD [®]	page	16
HPR260XD [®]	page	17
HPR400XD [®]	page	18
HPR400XD [®]	page	19
HSD130 [®] HySpeed	page	20
HT4400 [®] HySpeed	page	21

KJELLBERG[®]

PA-S20-25-40-45 [®]	page	22
PA-S47 [®] , FineFocus 450 [®]	page	23
HiFocus 80i [®]	page	24
HiFocus 100 [®]	page	25
HiFocus 130 [®]	page	26
HiFocus 160i [®]	page	27
HiFocus 160i (3D) [®]	page	28
HiFocus 280i-360i-440i [®] cutting up to 160A (YellowXLife)	page	29
HiFocus 280i-360i-440i [®] cutting up to 440A	page	30
HiFocus 280i-360i-440i [®] cutting up to 440A (YellowXLife)	page	31
FineFocus 800-900-1600 [®]	page	32
FineFocus 800-900-1600 [®] (YellowXLife)	page	33
PA-S50-75-76-77-150 [®]	page	34
PA-S50-75-76-77-150 [®] (YellowXLife)	page	35

SAF[®]

OCP-150 [®]	page	36
----------------------	------------	----

THERMAL DYNAMICS[®]

MERLIN 1000-3000-6000-6000 GST [®]	page	37
SL60-100 [®]	page	38
SL60-100 [®]	page	39



CEBORA[®]

Plasma system: PROF162[®]

Torch: CP200[®]

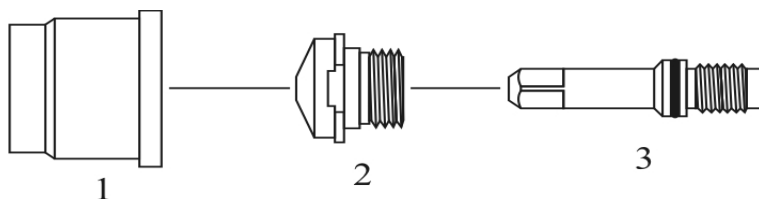

ITEM	REF. NUMBER	ORDER NUMBER	DESCRIPTION
01.	1905	BP-40101	Retaining cap 20A-200A
02.	1842	BP-40102	Nozzle - ø 1,0mm, 20A-50A
	1843	BP-40103	Nozzle - ø 1,3mm, 40A-90A
	1844	BP-40104	Nozzle - ø 1,6mm, 80A-120A
	1845	BP-40105	Nozzle - ø 1,8mm, 110A-150A
03.	1367	BP-40106	Electrode 20A-200A



ESAB[®] (L-TEC[®])

Plasma system: **PRECISION PLASMARC[®]**

Torch: **PT-24[®]**

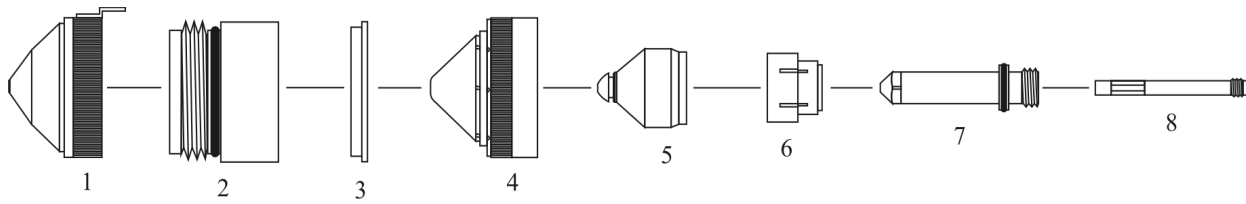

ITEM	REF. NUMBER	ORDER NUMBER	DESCRIPTION
01.	22531	BP-10101	Shield cap 15A-100A
02.	21712	BP-10102	Insulator shield retainer 15A-100A
03.	22010	BP-10103	Insulator ring 15A-100A
04.	22007	BP-10104	Retaining cap 15A-100A
05.	21540	BP-10105	Nozzle "A" 15A
	21541	BP-10106	Nozzle "B" 30A
	21542	BP-10107	Nozzle "C" 50A
	21543	BP-10108	Nozzle "D" 70A
	21923	BP-10109	Nozzle "E" 100A
06.	21852	BP-10110	Swirl ring 15A - 2 holes (vespel [®])
	21536	BP-10111	Swirl ring 30A - 3 holes (vespel [®])
	21692	BP-10112	Swirl ring 50A-100A - 4 holes (vespel [®])
07.	21539	BP-10113	Electrode 15A-100A
08.	21725	BP-10115	Cooling tube - PT-24 [®]



ESAB[®] (L-TEC[®])

Plasma system: ESP-200-300-400-600C-1000[®]

PCM-150-1500-8XL[®]

Torch: PT-600[®]

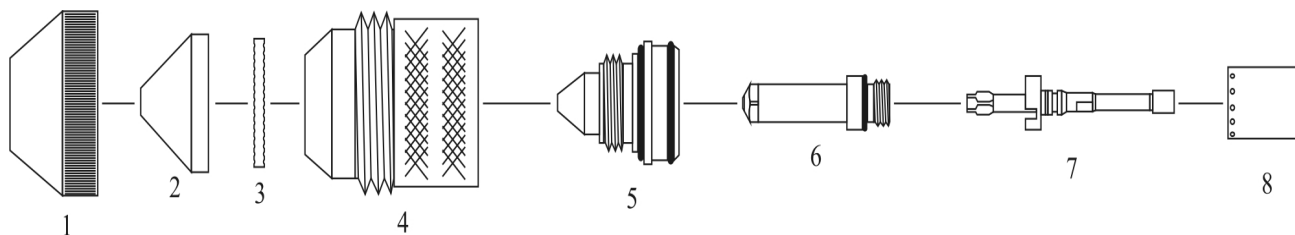

ITEM	REF. NUMBER	ORDER NUMBER	DESCRIPTION
01.	37081	BP-10201	Shield cap 50A-600A
02.	21796	BP-10202	Shield 50A
	21802	BP-10203	Shield 100A-250A
	21945	BP-10204	Shield 360A-600A
03.	21944	BP-10205	Diffuser 50A-600A
04.	37082	BP-10206	Retaining cap 50A-600A
05.	0558001881	BP-10207	Nozzle 50A
	0558001882	BP-10208	Nozzle 100A
	0558001883	BP-10209	Nozzle 150A
	0558001884	BP-10210	Nozzle 200A
	0558001623	BP-10211	Nozzle 250A
	0558001885	BP-10212	Nozzle 360A
	0558001886	BP-10213	Nozzle 400A
	0558001887	BP-10214	Nozzle 600A
06.	0558001624	BP-10220	Electrode 50A-250A
	0558002516	BP-10221	Electrode 360A-600A
07.	0558001621	BP-10217	Electrode holder 50A-600A
08.	0558002533	BP-10218	Swirl ring - 4 holes
	0558001625	BP-10219	Swirl ring - 8 holes

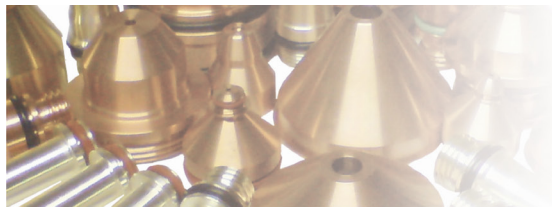

HYPERTHERM[®]

Plasma system: Powermax1000[®]

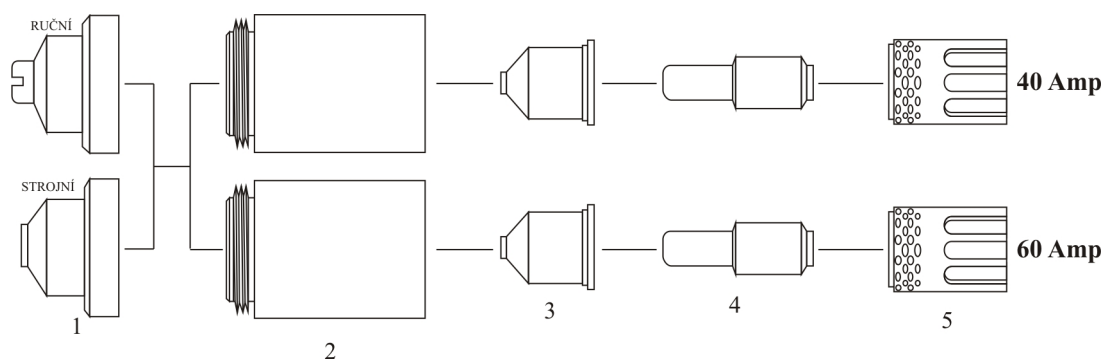

ITEM	REF. NUMBER	ORDER NUMBER	DESCRIPTION
01.	120929	BP-20101	Shield 40A-80A hand
	120930	BP-20102	Shield 40A-80A machine
02.	120928	BP-20103	Retaining cap 40A-80A
03.	120932	BP-20104	Nozzle 40A
	120931	BP-20105	Nozzle 60A
04.	120926	BP-20106	Electrode 40A-80A
05.	120925	BP-20107	Swirl ring 40A-80A (vespel [®])



HYPERTHERM[®]

Plasma system: Powermax1250[®]

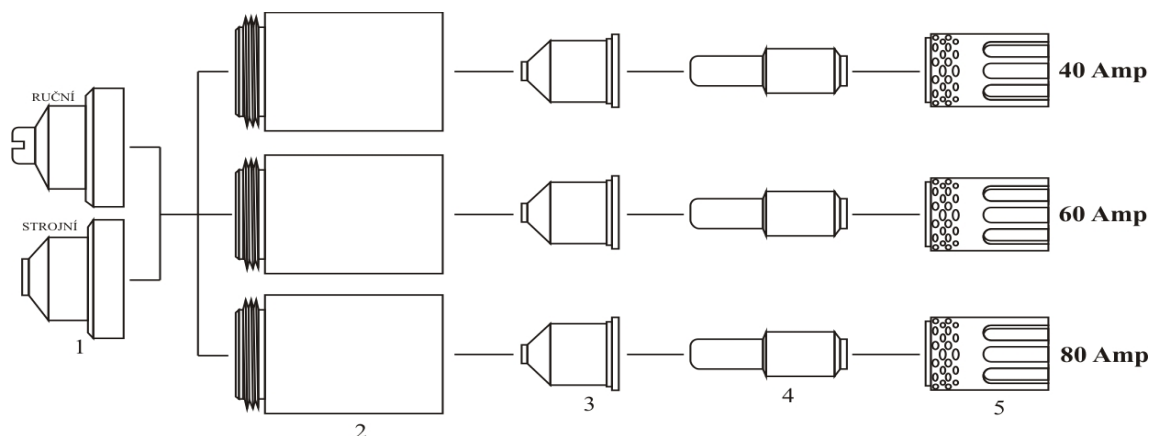

ITEM	REF. NUMBER	ORDER NUMBER	DESCRIPTION
01.	120929	BP-20101	Shield 40A-80A hand
	120930	BP-20102	Shield 40A-80A machine
02.	120928	BP-20103	Retaining cap 40A-80A
03.	120932	BP-20104	Nozzle 40A
	120931	BP-20105	Nozzle 60A
	120927	BP-20201	Nozzle 80A
04.	120926	BP-20106	Electrode 40A-80A
05.	120925	BP-20107	Swirl ring 40A-80A (vespel [®])

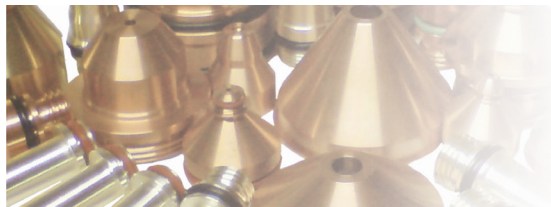

HYPERTHERM[®]

Plasma system: Powermax1650[®]

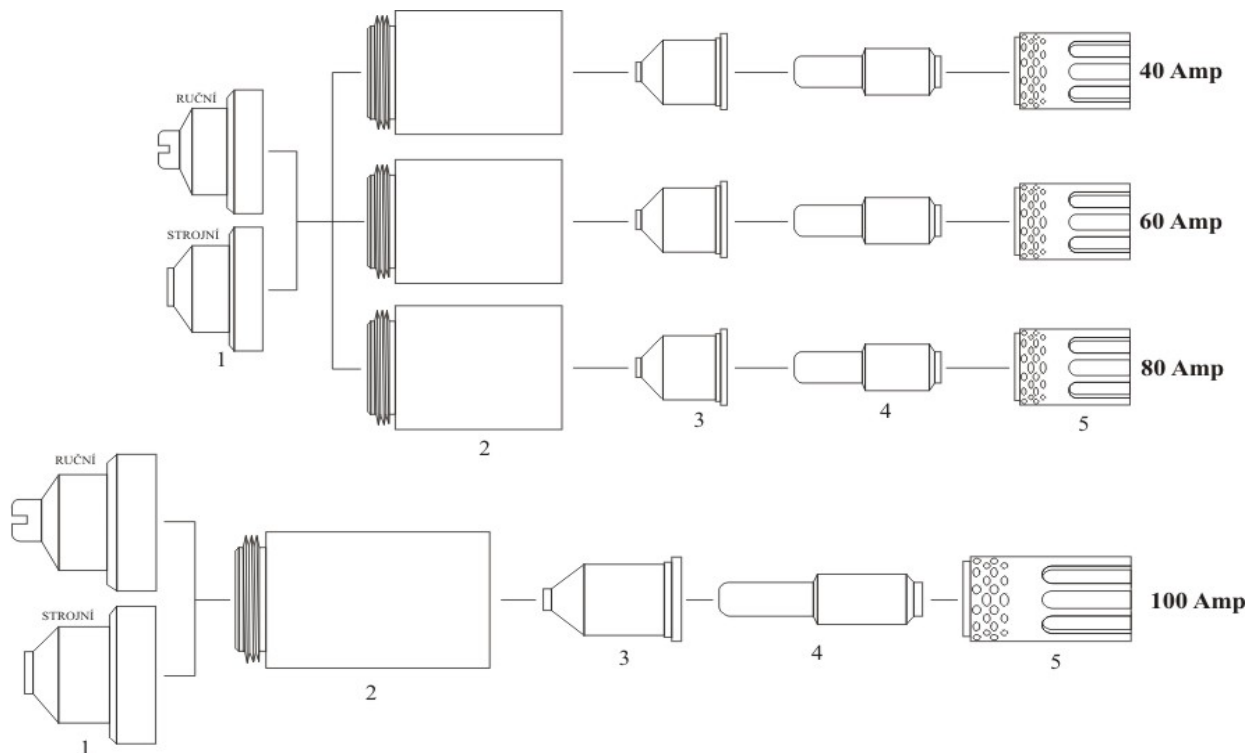

ITEM	REF. NUMBER	ORDER NUMBER	DESCRIPTION
01.	120929	BP-20101	Shield 40A-80A hand
	120930	BP-20102	Shield 40A-80A machine
	220065	BP-20301	Shield 100A hand
	220047	BP-20302	Shield 100A machine
02.	120928	BP-20103	Retaining cap 40A-80A
	220048	BP-20303	Retaining cap 100A
03.	120932	BP-20104	Nozzle 40A
	120931	BP-20105	Nozzle 60A
	120927	BP-20201	Nozzle 80A
	220011	BP-20304	Nozzle 100A
04.	120926	BP-20106	Electrode 40A-80A
	220037	BP-20305	Electrode 100A
05.	120925	BP-20107	Swirl ring 40A-80A (vespel [®])
	220051	BP-20306	Swirl ring 100A (vespel [®])



HYPERTHERM[®]

Plasma system: MAX200[®]

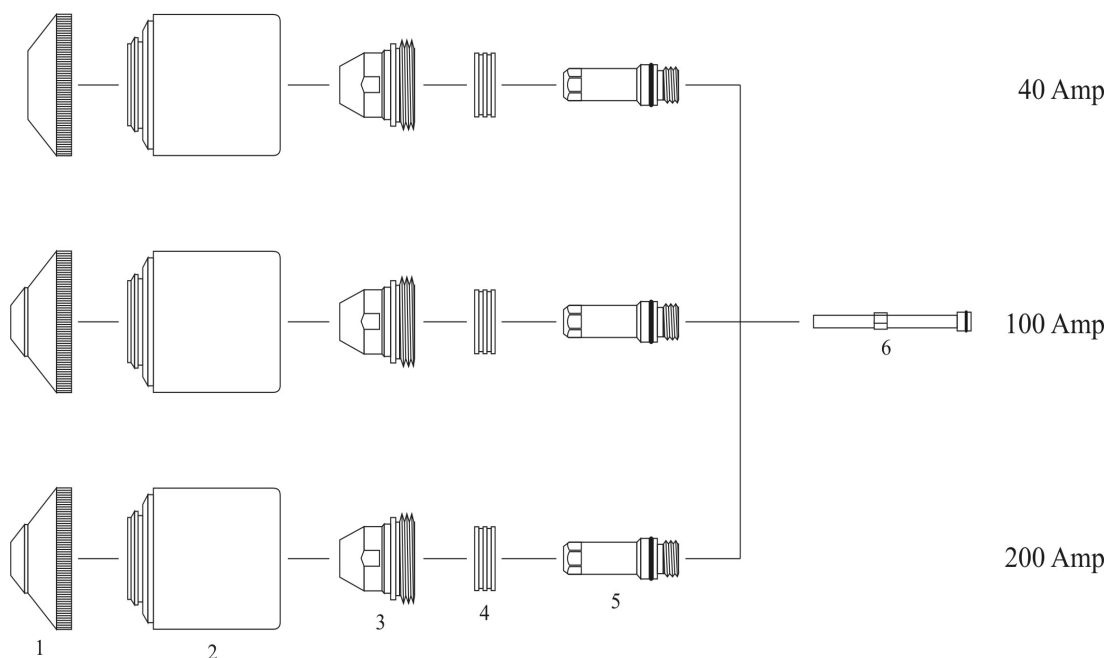

ITEM	REF. NUMBER	ORDER NUMBER	DESCRIPTION
01.	020688	BP-20401	Shield 40A, Air
	020448	BP-20402	Shield 100A, Air, O2, N2, Ar/H
	020424	BP-20403	Shield 200A, Air, O2, N2, Ar/H
02.	020423	BP-20404	Retaining cap 40A-200A
03.	020689	BP-20405	Nozzle 40A, .038, Air
	020611	BP-20406	Nozzle 100A, .059, Air, N2, Ar/H
	020608	BP-20407	Nozzle 200A, .086, Air, N2, Ar/H
	020616	BP-20408	Nozzle 100A, .055, O2
	020605	BP-20409	Nozzle 200A, .082, O2
04.	020613	BP-20410	Swirl ring 40A, Air
	020607	BP-20411	Swirl ring 100A-200A, Air, N2, Ar/H
	020617	BP-20412	Swirl ring 100A, O2
	020604	BP-20413	Swirl ring 200A, O2
05.	120547	BP-20414	Electrode 100A, Air, O2
	120667	BP-20416	Electrode 40A-200A, Air, O2
	220021	BP-20419	Electrode 200A, Air, O2
	020415	BP-20418	Electrode 100A-200A N2, Ar/H
06.	020963	BP-20420	Water tube 40A-100A-200A, standard



HYPERTHERM[®]

Plasma system: HT2000[®]

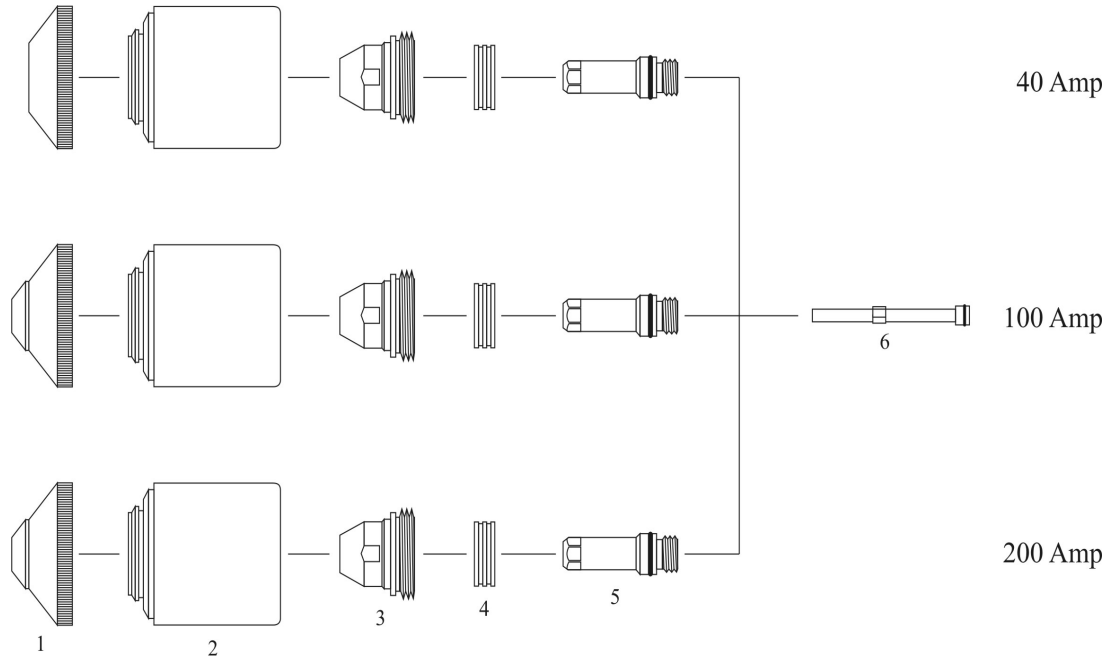

ITEM	REF. NUMBER	ORDER NUMBER	DESCRIPTION
01.	020688	BP-20401	Shield 40A, Air
	020448	BP-20402	Shield 100A, Air, O2, N2, Ar/H
	020424	BP-20403	Shield 200A, Air, O2, N2, Ar/H
02.	020423	BP-20404	Retaining cap 40A-200A
03.	020689	BP-20405	Nozzle 40A, .038, Air
	020611	BP-20406	Nozzle 100A, .059, Air, N2, Ar/H
	020608	BP-20407	Nozzle 200A, .086, Air, N2, Ar/H
	020690	BP-20501	Nozzle 100A, .055, O2
	020605	BP-20409	Nozzle 200A, .082, O2
04.	020613	BP-20410	Swirl ring 40A, Air
	020607	BP-20411	Swirl ring 100A-200A, Air, N2, Ar/H
	020617	BP-20412	Swirl ring 100A, O2
	020679	BP-20502	Swirl ring 200A, Air
	120833	BP-20503	Swirl ring 200A, O2
05.	120547	BP-20414	Electrode 100A, Air, O2
	120667	BP-20416	Electrode 40A-200A, Air, O2
	020415	BP-20418	Electrode 100A-200A N2, Ar/H
06.	020963	BP-20420	Water tube 40A-50A-100A-200A, standard



HYPERTHERM[®]

Plasma system: HT2000[®] HySpeed

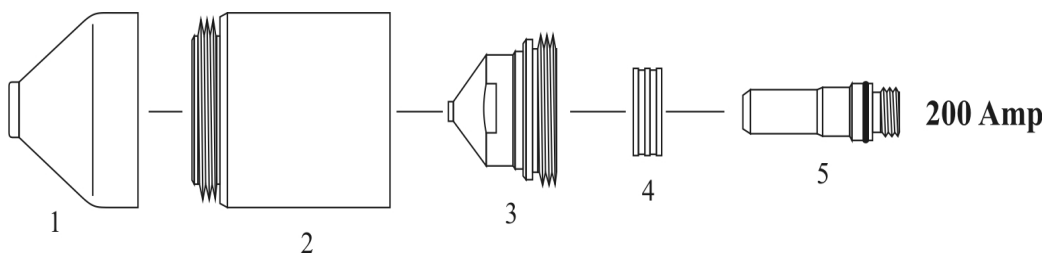

ITEM	REF. NUMBER	ORDER NUMBER	DESCRIPTION
01.	220239	BP-20601	Shield 200A O2 HySpeed
02.	220238	BP-20602	Retaining cap 200A O2 HySpeed
03.	220237	BP-20603	Nozzle 200A O2 HySpeed
04.	220236	BP-20604	Swirl ring 200A, O2 HySpeed
05.	220235	BP-20605	Electrode 200A O2 HySpeed



HYPERTHERM[®]

Plasma system: HPR HD3070[®] upgrade

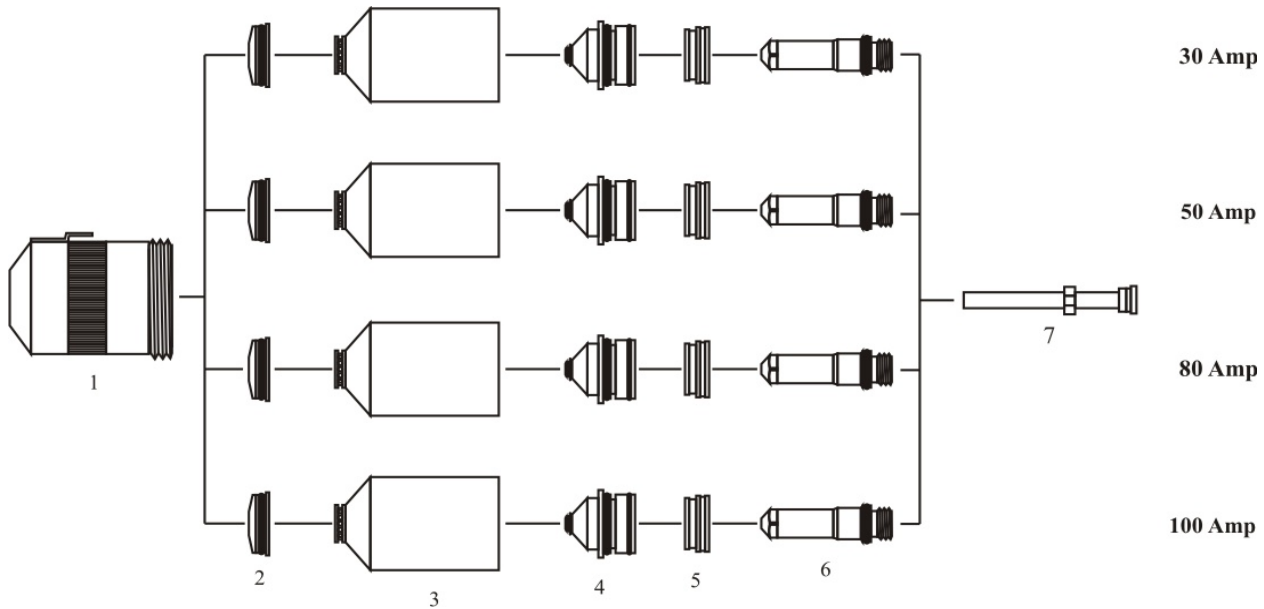

ITEM	REF. NUMBER	ORDER NUMBER	DESCRIPTION
01.	220173	BP-20901	Shield cap 30A-50A-80A-130A
02.	220194	BP-20902	Shield 30A
	220555	BP-20918	Shield 50A
	220189	BP-20903	Shield 80A
	220183	BP-20904	Shield 100A
03.	220313	BP-20905	Retaining cap 30A-50A
	220176	BP-20906	Retaining cap 80A-100A
04.	220193	BP-20907	Nozzle 30A
	220554	BP-20919	Nozzle 50A
	220188	BP-20908	Nozzle 80A
	220510	BP-21101	Nozzle 100A
05.	220180	BP-20910	Swirl ring 30A
	220553	BP-20920	Swirl ring 50A
	220179	BP-20911	Swirl ring 80A-100A
06.	220192	BP-20912	Electrode 30A
	220552	BP-20921	Electrode 50A
	220187	BP-20913	Electrode 80A
	220181	BP-20915	Electrode 100A
07.	220340	BP-20917	Water tube 30A-50A-80A-100A



HYPERTHERM[®]

Plasma system: HPR HD4070[®] upgrade

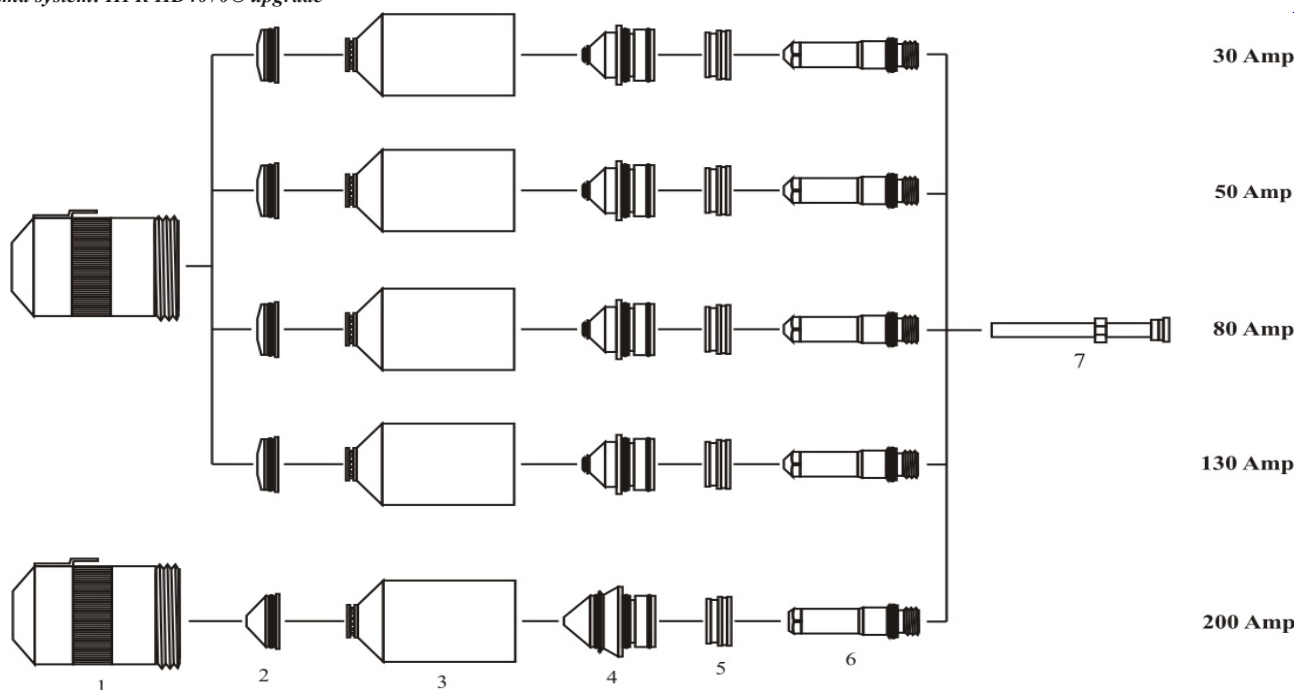

ITEM	REF. NUMBER	ORDER NUMBER	DESCRIPTION
01.	220173	BP-20901	Shield cap 30A-50A-80A-130A
	220398	BP-21001	Shield cap 200A-260A
02.	220194	BP-20902	Shield 30A
	220555	BP-20918	Shield 50A
	220189	BP-20903	Shield 80A
	220183	BP-20904	Shield 130A
	220356	BP-21002	Shield 200A
03.	220313	BP-20905	Retaining cap 30A-50A
	220176	BP-20906	Retaining cap 80A-130A
	220355	BP-21004	Retaining cap 200A
04.	220193	BP-20907	Nozzle 30A
	220554	BP-20919	Nozzle 50A
	220188	BP-20908	Nozzle 80A
	220182	BP-20909	Nozzle 130A
	220354	BP-21006	Nozzle 200A
05.	220180	BP-20910	Swirl ring 30A
	220553	BP-20920	Swirl ring 50A
	220179	BP-20911	Swirl ring 80A-130A
	220353	BP-21008	Swirl ring 200A
06.	220192	BP-20912	Electrode 30A
	220552	BP-20921	Electrode 50A
	220187	BP-20913	Electrode 80A
	220181	BP-20915	Electrode 130A
	220352	BP-21010	Electrode 200A
07.	220340	BP-20917	Water tube 30A-50A-80A-130A-200A

HYPERTHERM[®], HPR HD4070[®] upgrade are the Registered Trademarks of HYPERTHERM[®]. B&BARTONI, spol. s r.o. is in no way affiliated with HYPERTHERM[®]. The parts advertised for sale are not genuine HYPERTHERM[®] parts, but are parts made for and by B&BARTONI, spol. s r.o.. Reference to HYPERTHERM[®] machine, torches and numbers are for your convenience only. We reserve the right to substitute genuine HYPERTHERM[®] parts in place of B&BARTONI, spol. s r.o. parts. Parts indicated with a "OEM" are original parts manufactured by the above named manufacturer and are being resold by B&BARTONI, spol. s r.o..



HYPERTHERM[®]

Plasma system: HPR130[®]

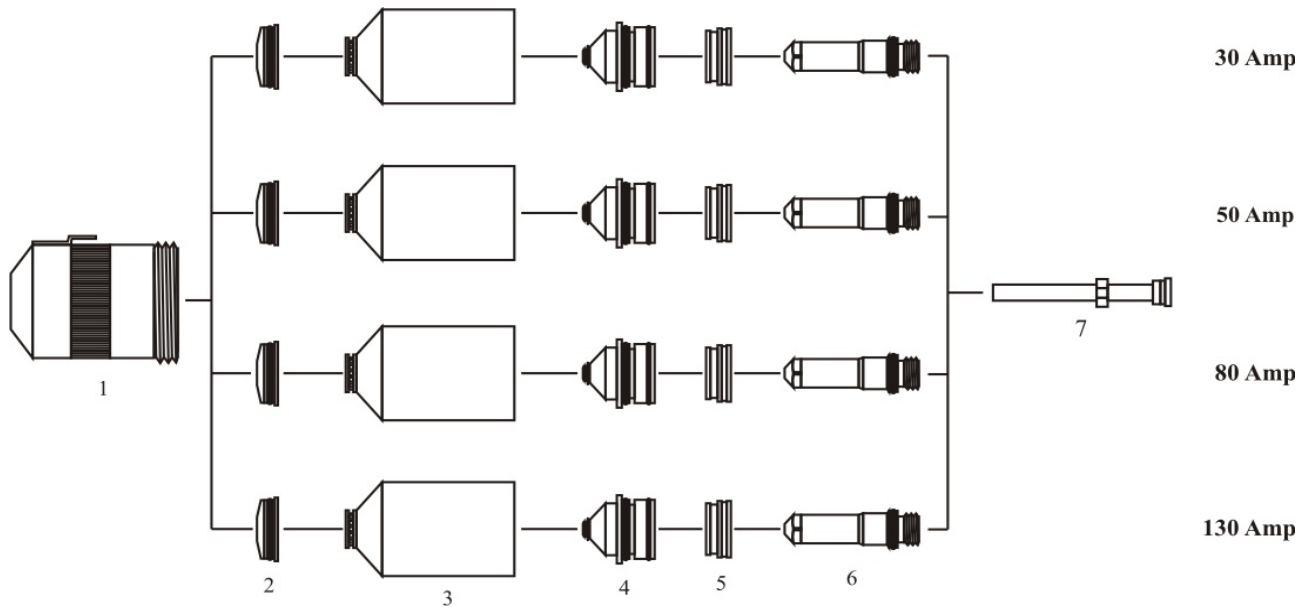

ITEM	REF. NUMBER	ORDER NUMBER	DESCRIPTION
01.	220173	BP-20901	Shield cap 30A-50A-80A-130A
02.	220194	BP-20902	Shield 30A
	220555	BP-20918	Shield 50A
	220189	BP-20903	Shield 80A
	220183	BP-20904	Shield 130A
03.	220313	BP-20905	Retaining cap 30A-50A
	220176	BP-20906	Retaining cap 80A-130A
04.	220193	BP-20907	Nozzle 30A
	220554	BP-20919	Nozzle 50A
	220188	BP-20908	Nozzle 80A
	220182	BP-20909	Nozzle 130A
05.	220180	BP-20910	Swirl ring 30A
	220553	BP-20920	Swirl ring 50A
	220179	BP-20911	Swirl ring 80A-130A
06.	220192	BP-20912	Electrode 30A
	220552	BP-20921	Electrode 50A
	220187	BP-20913	Electrode 80A
	220181	BP-20915	Electrode 130A
07.	220340	BP-20917	Water tube 30A-50A-80A-130A



HYPERTHERM[®]

Plasma system: HPR260[®]

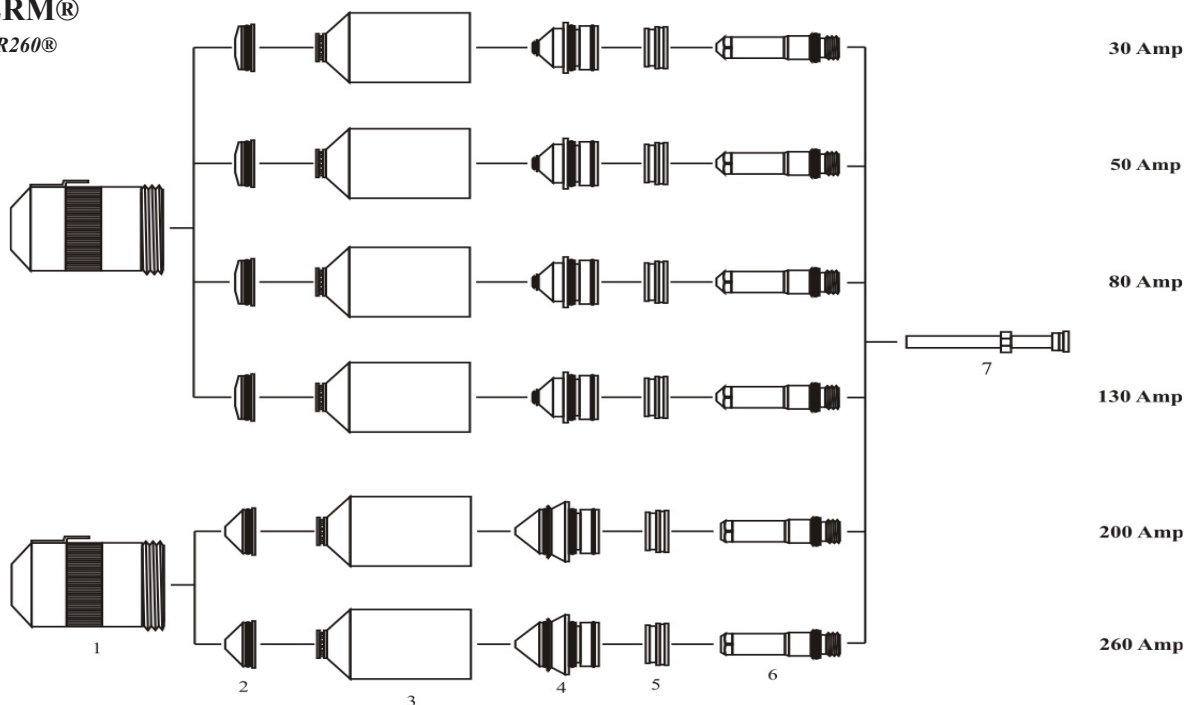

ITEM	REF. NUMBER	ORDER NUMBER	DESCRIPTION
01.	220173	BP-20901	Shield cap 30A-50A-80A-130A
	220398	BP-21001	Shield cap 200A-260A
02.	220194	BP-20902	Shield 30A
	220555	BP-20918	Shield 50A
	220189	BP-20903	Shield 80A
	220183	BP-20904	Shield 130A
	220356	BP-21002	Shield 200A
	220440	BP-21003	Shield 260A
03.	220313	BP-20905	Retaining cap 30A-50A
	220176	BP-20906	Retaining cap 80A-130A
	220355	BP-21004	Retaining cap 200A
	220433	BP-21005	Retaining cap 260A
04.	220193	BP-20907	Nozzle 30A
	220554	BP-20919	Nozzle 50A
	220188	BP-20908	Nozzle 80A
	220182	BP-20909	Nozzle 130A
	220354	BP-21006	Nozzle 200A
	220439	BP-21007	Nozzle 260A
05.	220180	BP-20910	Swirl ring 30A
	220553	BP-20920	Swirl ring 50A
	220179	BP-20911	Swirl ring 80A-130A
	220353	BP-21008	Swirl ring 200A
	220436	BP-21009	Swirl ring 260A
06.	220192 / 220552	BP-20912 / BP-20921	Electrode 30A / 50A
	220187 / 220181	BP-20913 / BP-20915	Electrode 80A / 130A
	220352 / 220435	BP-21010 / BP-21012	Electrode 200A / 260A
07.	220340	BP-20917	Water tube 30A-50A-80A-130A-260A

HYPERTHERM[®], HPR260[®] are the Registered Trademarks of HYPERTHERM[®]. B&BARTONI, spol. s r.o. is in no way affiliated with HYPERTHERM[®]. The parts advertised for sale are not genuine HYPERTHERM[®] parts, but are parts made for and by B&BARTONI, spol. s r.o.. Reference to HYPERTHERM[®] machine, torches and numbers are for your convenience only. We reserve the right to substitute genuine HYPERTHERM[®] parts in place of B&BARTONI, spol. s r.o. parts. Parts indicated with a "OEM" are original parts manufactured by the above named manufacturer and are being resold by B&BARTONI, spol. s r.o..



HYPERTHERM[®]

Plasma system: **HPR130XD[®]**

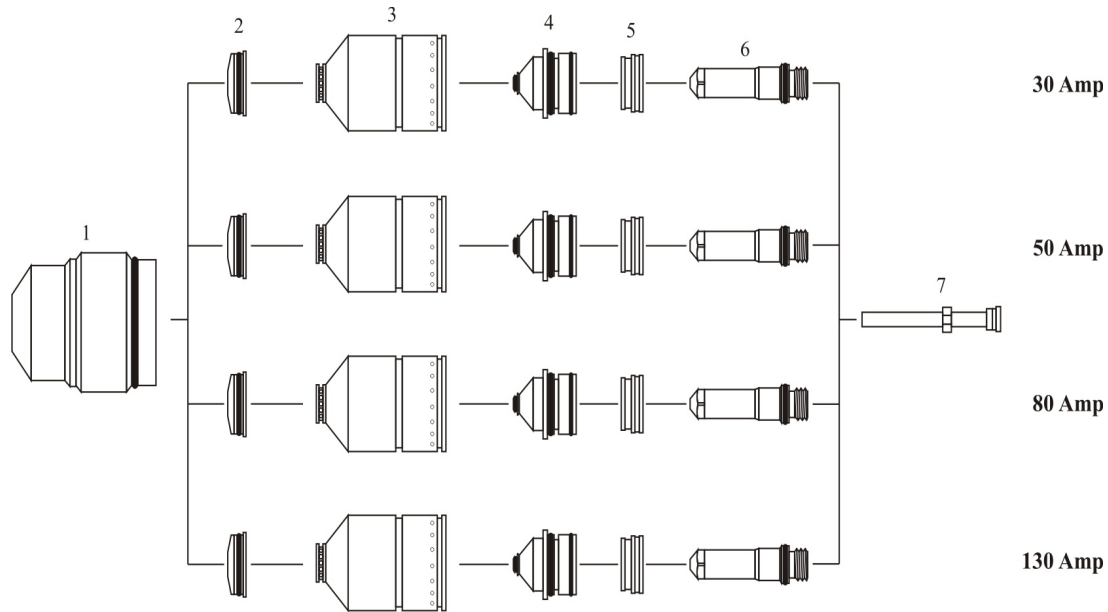

ITEM	REF. NUMBER	ORDER NUMBER	DESCRIPTION
01.	220747	BP-21201	Shield cap 30A-50A-80A-130A
02.	220194	BP-20902	Shield 30A
	220555	BP-20918	Shield 50A
	220189	BP-20903	Shield 80A
	220183	BP-20904	Shield 130A
03.	220754	BP-21202	Retaining cap 30A-50A
	220756	BP-21203	Retaining cap 80A-130A
04.	220193	BP-20907	Nozzle 30A
	220554	BP-20919	Nozzle 50A
	220188	BP-20908	Nozzle 80A
	220182	BP-20909	Nozzle 130A
05.	220180	BP-20910	Swirl ring 30A
	220553	BP-20920	Swirl ring 50A
	220179	BP-20911	Swirl ring 80A-130A
06.	220192	BP-20912	Electrode 30A
	220552	BP-20921	Electrode 50A
	220187	BP-20913	Electrode 80A
	220181	BP-20915	Electrode 130A
07.	220340	BP-20917	Water tube 30A-50A-80A-130A



HYPERTHERM[®]

Plasma system: HPR260XD[®]

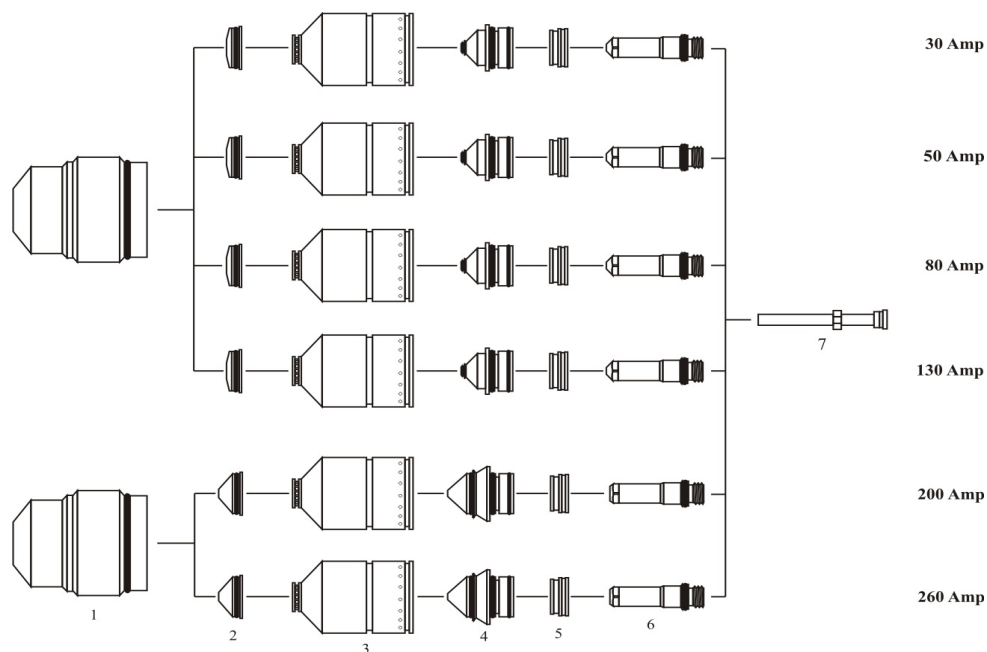

ITEM	REF. NUMBER	ORDER NUMBER	DESCRIPTION
01.	220747	BP-21201	Shield cap 30A-50A-80A-130A
	220637	BP-21301	Shield cap 200A-260A
02.	220194	BP-20902	Shield 30A
	220555	BP-20918	Shield 50A
	220189	BP-20903	Shield 80A
	220183	BP-20904	Shield 130A
	220761	BP-21302	Shield 200A
	220764	BP-21303	Shield 260A
03.	220754	BP-21202	Retaining cap 30A-50A
	220756	BP-21203	Retaining cap 80A-130A
	220757	BP-21304	Retaining cap 200A
	220760	BP-21305	Retaining cap 260A
04.	220193	BP-20907	Nozzle 30A
	220554	BP-20919	Nozzle 50A
	220188	BP-20908	Nozzle 80A
	220182	BP-20909	Nozzle 130A
	220354	BP-21006	Nozzle 200A
	220439	BP-21007	Nozzle 260A
05.	220180	BP-20910	Swirl ring 30A
	220553	BP-20920	Swirl ring 50A
	220179	BP-20911	Swirl ring 80A-130A
	220353	BP-21008	Swirl ring 200A
	220436	BP-21009	Swirl ring 260A
06.	220192	BP-20912	Electrode 30A
	220552	BP-20921	Electrode 50A
	220187	BP-20913	Electrode 80A
	220181	BP-20915	Electrode 130A
	220352	BP-21010	Electrode 200A
	220435	BP-21012	Electrode 260A
07.	220340	BP-20917	Water tube 30A-50A-80A-130A-200A-260A



HYPERTHERM[®]

Plasma system: HPR400XD[®]

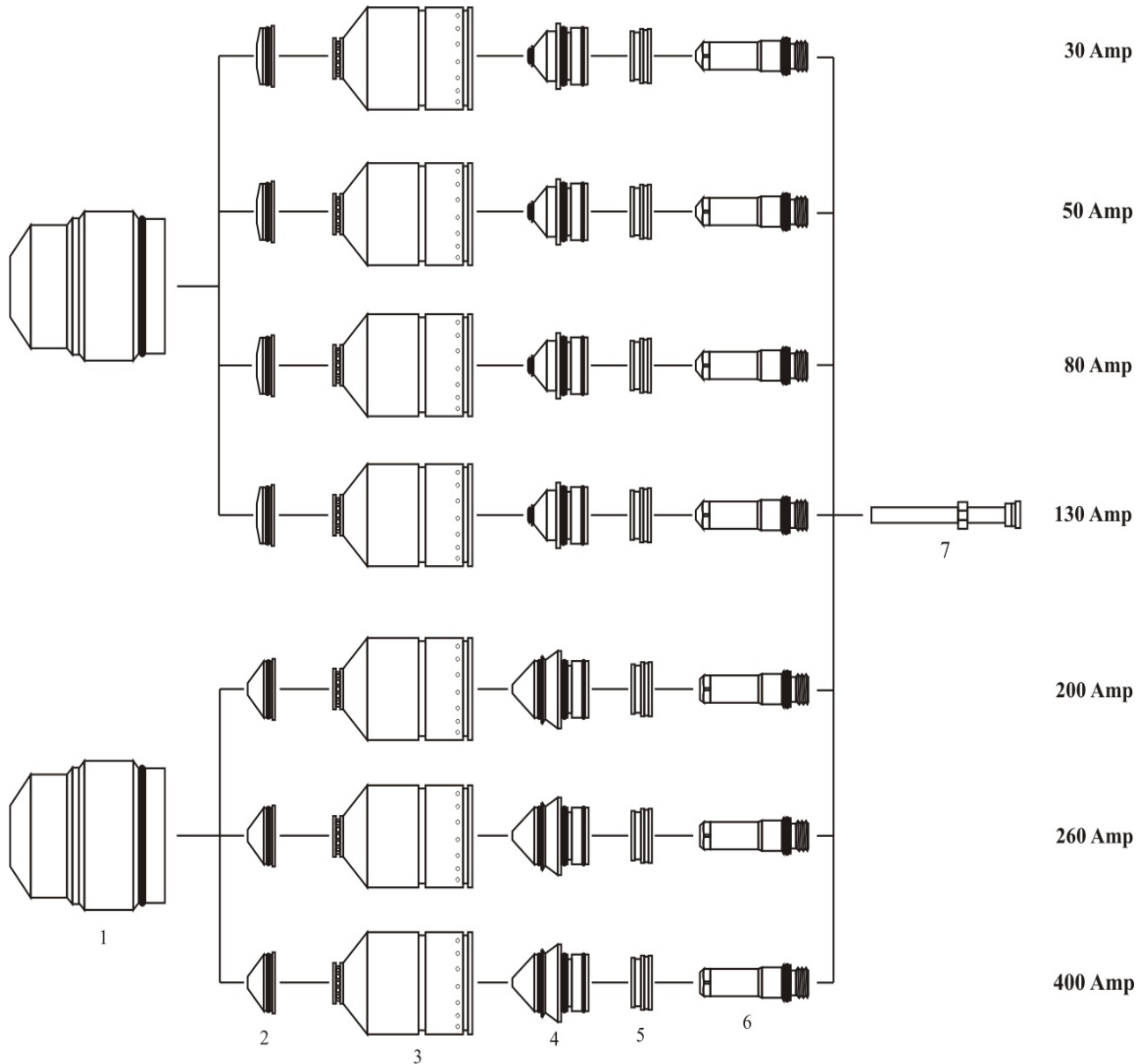



HYPERTHERM[®]

Plasma system: HPR400XD[®]

ITEM	REF. NUMBER	ORDER NUMBER	DESCRIPTION
01.	220747	BP-21201	Shield cap 30A-50A-80A-130A
	220637	BP-21301	Shield cap 200A-260A
02.	220194	BP-20902	Shield 30A
	220555	BP-20918	Shield 50A
	220189	BP-20903	Shield 80A
	220183	BP-20904	Shield 130A
	220761	BP-21302	Shield 200A
	220764	BP-21303	Shield 260A
	220636	BP-21401	Shield 400A
03.	220754	BP-21202	Retaining cap 30A-50A
	220756	BP-21203	Retaining cap 80A-130A
	220757	BP-21304	Retaining cap 200A
	220760	BP-21305	Retaining cap 260A
	220635	BP-21402	Retaining cap 400A
04.	220193	BP-20907	Nozzle 30A
	220554	BP-20919	Nozzle 50A
	220188	BP-20908	Nozzle 80A
	220182	BP-20909	Nozzle 130A
	220354	BP-21006	Nozzle 200A
	220439	BP-21007	Nozzle 260A
	220632	BP-21403	Nozzle 400A
05.	220180	BP-20910	Swirl ring 30A
	220553	BP-20920	Swirl ring 50A
	220179	BP-20911	Swirl ring 80A-130A
	220353	BP-21008	Swirl ring 200A
	220436	BP-21009	Swirl ring 260A
	220631	BP-21404	Swirl ring 400A
06.	220192	BP-20912	Electrode 30A
	220552	BP-20921	Electrode 50A
	220187	BP-20913	Electrode 80A
	220181	BP-20915	Electrode 130A
	220352	BP-21010	Electrode 200A
	220435	BP-21012	Electrode 260A
	220629	BP-21405	Electrode 400A
07.	220340	BP-20917	Water tube 30A-50A-80A-130A-200A-260A
	220571	BP-21407	Water tube 400A



HYPERTHERM[®]

Plasma system: HSD130[®] HySpeed

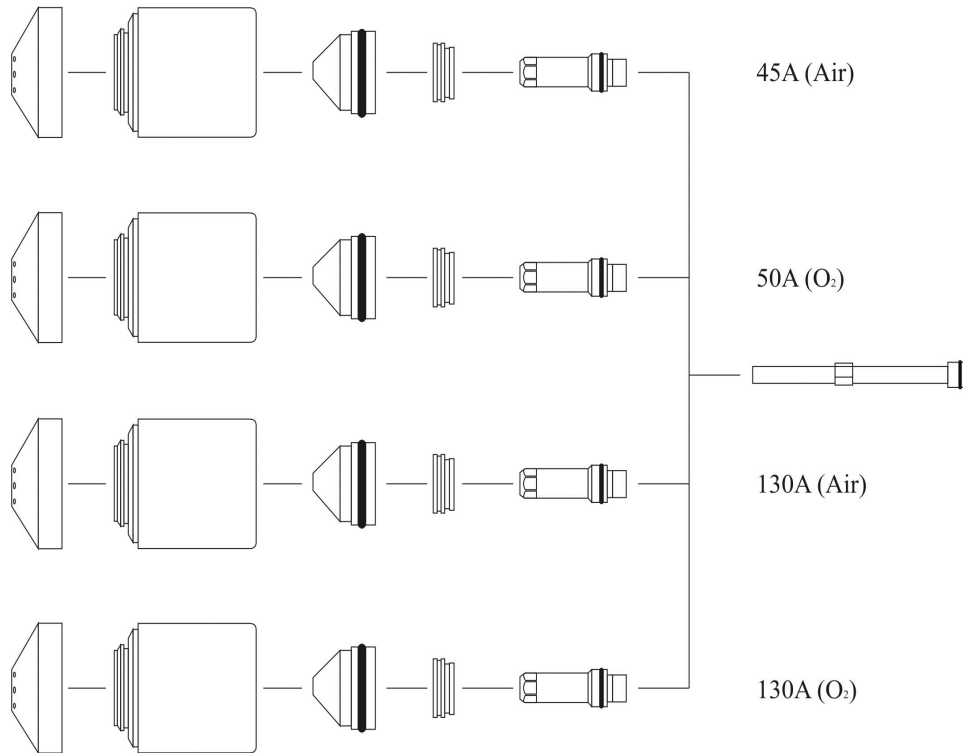

ITEM	REF. NUMBER	ORDER NUMBER	DESCRIPTION
01.	220532	BP-21101	Shield 45A Air, 50A O2
	220536	BP-21102	Shield 130A Air
	220491	BP-21103	Shield 130A O2
02.	220578	BP-21104	Retaining cap 45A-50A-130A
03.	220525	BP-21105	Nozzle 45A Air
	220530	BP-21106	Nozzle 50A O2
	220492	BP-21107	Nozzle 130A Air
	220489	BP-21108	Nozzle 130A O2
04.	220529	BP-21109	Swirl ring 45A Air, 50A O2
	220488	BP-21110	Swirl ring 130A Air, O2
05.	220528	BP-21111	Electrode 45A Air, 50A O2
	220487	BP-21112	Electrode 130A Air, O2
06.	220521	BP-21114	Water tube 45A-50A-130A, Air, O2



HYPERTHERM[®]

Plasma system: HT4400[®] HySpeed

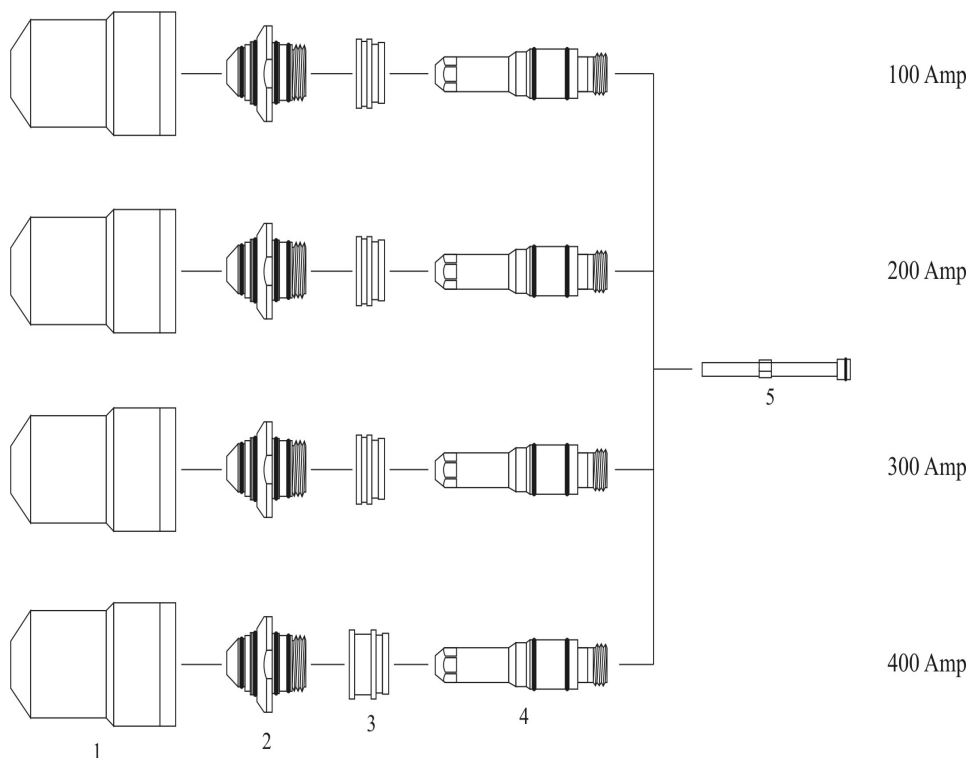

ITEM	REF. NUMBER	ORDER NUMBER	DESCRIPTION
01.	120786	BP-21501	Retaining cap 100A-200A-300A-400A
02.	120777	BP-21503	Nozzle 100A O2
	120787	BP-21504	Nozzle 200A O2
	120794	BP-21505	Nozzle 300A O2
	120934	BP-21506	Nozzle 400A O2
03.	120783	BP-21507	Swirl ring 100A O2 "OEM"
	120791	BP-21508	Swirl ring 200A O2 "OEM"
	120913	BP-21509	Swirl ring 300A O2 "OEM"
	120939	BP-21510	Swirl ring 400A O2 "OEM"
04.	120785	BP-21511	Electrode 100A O2
	120793	BP-21513	Electrode 200A O2
	120802	BP-21515	Electrode 300A O2
	120810	BP-21517	Electrode 400A O2
05.	120025	BP-21519	Water tube 100A-200A-300A-400A



KJELLBERG[®]

Plasma system: PA-S20-25-40-45 W[®]

Torch: PB-S25-44-45 W[®]

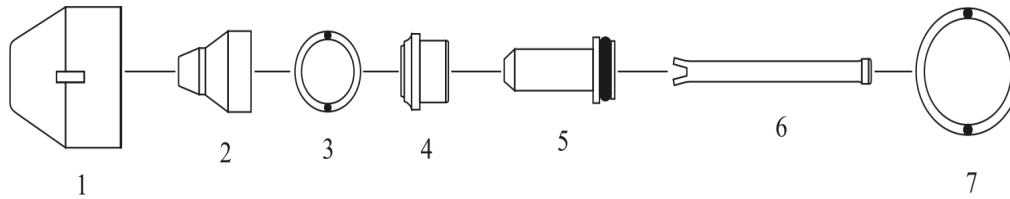

ITEM	REF. NUMBER	ORDER NUMBER	DESCRIPTION
01.	.11.830.301.151	BP-30101	Shield cap - ø 9,6mm
02.	.11.828.203.410	BP-30102	Nozzle Lle - ø 1,0mm, 45A, Air
	.11.828.203.413	BP-30103	Nozzle Lde - ø 1,3mm, 90A, Air
	.11.828.203.414	BP-30104	Nozzle Lee - ø 1,4mm, 130A, Air
03.	.10.575.036	BP-30105	"O" - ring 12x1,5 silicone
04.	.11.828.001.153	BP-30106	Swirl ring Air (vespel [®])
05.	.11.828.001.3001	BP-30107	Cathode Kb Air
06.	.11.828.001.152	BP-30108	Cooling tube - PB-S45
07.	.10.575.052	BP-30109	"O" - ring 20x2,0 silicone



KJELLBERG[®]

Plasma system: PA-S47 W[®], FineFocus 450[®]

Torch: PB-S47 W[®]

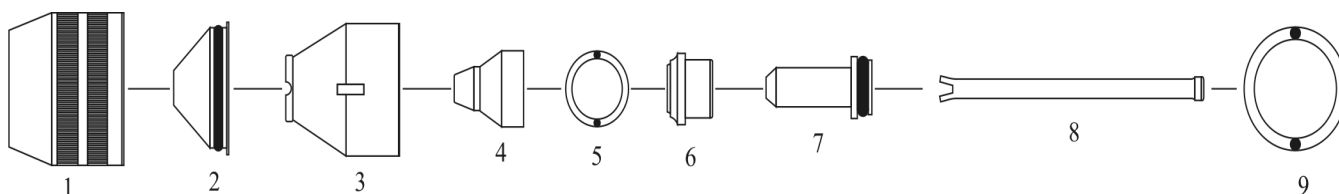

ITEM	REF. NUMBER	ORDER NUMBER	DESCRIPTION
01.	.11.832.201.081	BP-30201	Shield cap - PB-S46/47
02.	.11.832.201.1561	BP-30202	Shield W4130 - ø 3,0mm
	.11.832.201.1571	BP-30203	Shield W4140 - ø 4,0mm
03.	.11.832.201.160	BP-30204	Retaining cap V3030 - PB-S46/47
04.	.11.834.321.410	BP-30205	Nozzle Lle-XL - ø 1,0mm, 45A, O2
	.11.834.321.413	BP-30206	Nozzle Lde-XL - ø 1,3mm, 90A, O2
	.11.834.321.414	BP-30207	Nozzle Lee-XL - ø 1,4mm, 130A, O2
05.	.10.575.036	BP-30105	"O" - ring 12x1,5 silicone
06.	.11.834.321.153	BP-30208	Swirl ring Z111 (vespel [®])
07.	.11.834.321.3001AG	BP-30209	Cathode Kb-XL O2 SILVER
08.	.11.832.201.152	BP-30210	Cooling tube - PB-S46/47
09.	.10.575.052	BP-30109	"O" - ring 20x2,0 silicone



KJELLBERG[®]

Plasma system: *HiFocus 80i[®]*

Torch: *PerCut 80/90[®]*

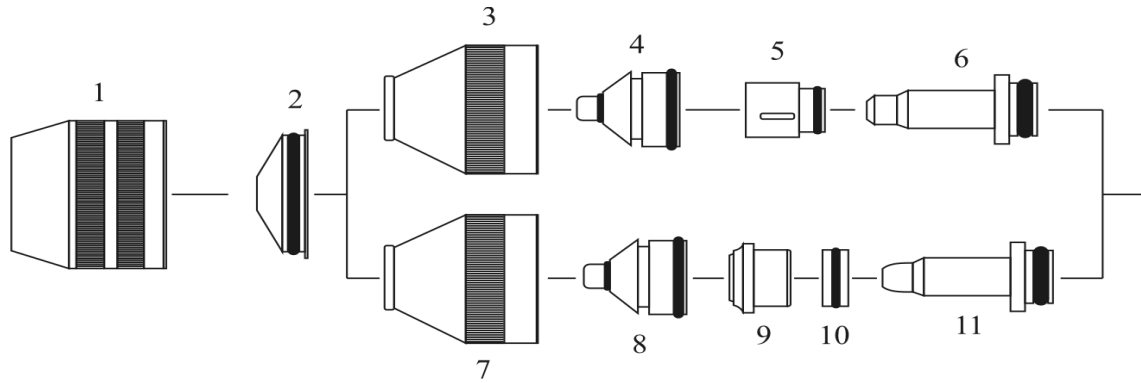

ITEM	REF. NUMBER	ORDER NUMBER	DESCRIPTION
01.	.11.835.201.081	BP-30401	Shield cap Z501
02.	.11.835.201.1561	BP-30402	Shield Z4015 - ø 1,5mm
	.11.835.201.1571	BP-30403	Shield Z4020 - ø 2,0mm
	.11.835.201.1551	BP-30501	Shield Z4022 - ø 2,2mm
	.11.835.201.1581	BP-30404	Shield Z4025 - ø 2,5mm
	.11.835.201.1591	BP-30405	Shield Z4030 - ø 3,0mm
	.11.835.401.1571	BP-30406	Shield Z4140 - ø 4,0mm
03.	.11.845.401.160	BP-30301	Retaining cap M3004 - ø 0,4mm "OEM"
04.	.11.845.421.406	BP-30302	Nozzle M2006 - ø 0,6mm 25A, Air, O2
	.11.845.421.407	BP-30303	Nozzle M2007 - ø 0,7mm 35A, Air, O2
	.11.845.421.408	BP-30304	Nozzle M2008 - ø 0,8mm 50A, Air, O2
	.11.845.421.409	BP-30305	Nozzle M2009 - ø 0,9mm 70A, Air, O2
	.11.845.421.410	BP-30306	Nozzle M2010 - ø 1,0mm 80A, Air, O2
05.	.11.835.221.153	BP-30415	Swirl ring Z101 - 3 holes (vespel [®])
	.11.835.221.154	BP-30512	Swirl ring Z102 - 2 holes (vespel [®])
06.	.11.845.401.300	BP-30307	Cathode M001 Air
	.11.845.421.310AG	BP-30308	Cathode M002-XL O2 SILVER
07.	.11.845.401.162	BP-30309	Retaining cap M3008 - ø 0,8mm "OEM"
	.11.845.401.1622	BP-30310	Retaining cap M3028 - ø 0,8mm "OEM"
08.	.11.845.521.412	BP-30311	Nozzle M2112 - ø 1,2mm 100A, Air, O2
09.	.11.834.321.153	BP-30208	Swirl ring Z111 (vespel [®])
10.	.11.835.421.303	BP-30420	Spacer ring Z111A (vespel [®])
11.	.11.845.501.300	BP-30312	Cathode M011 Air
	.11.845.521.3101AG	BP-30313	Cathode M012-XL O2 SILVER

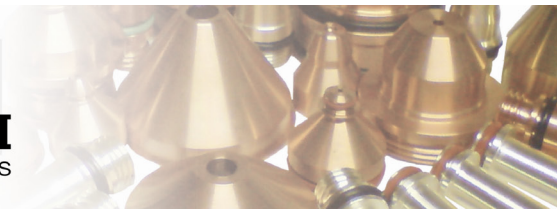

KJELLBERG[®]

Plasma system: **HiFocus 100[®]**

Torch: **PerCut 101[®]**

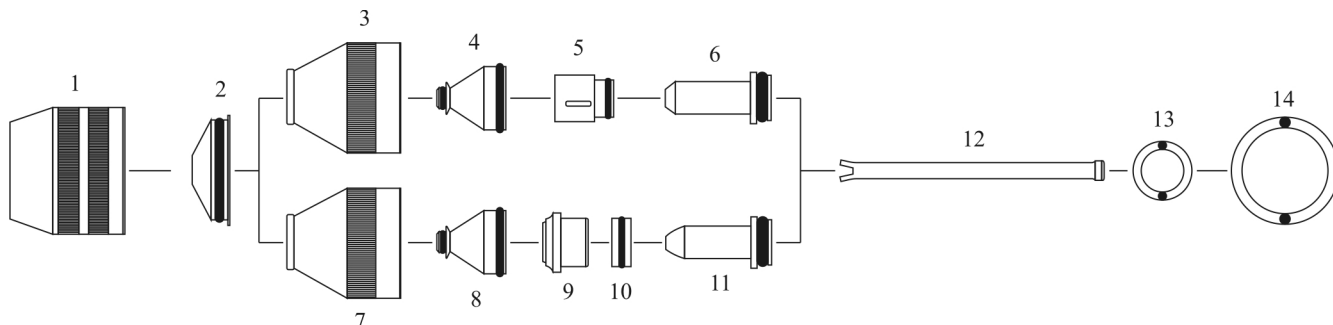

ITEM	REF. NUMBER	ORDER NUMBER	DESCRIPTION
01.	.11.835.201.081	BP-30401	Shield cap Z501
02.	.11.835.201.1561	BP-30402	Shield Z4015 - ø 1,5mm
	.11.835.201.1571	BP-30403	Shield Z4020 - ø 2,0mm
	.11.835.201.1581	BP-30404	Shield Z4025 - ø 2,5mm
	.11.835.201.1591	BP-30405	Shield Z4030 - ø 3,0mm
	.11.835.401.1571	BP-30406	Shield Z4140 - ø 4,0mm
03.	.11.835.201.160	BP-30407	Retaining cap Z3004 - ø 0,4mm
04.	.11.835.221.406	BP-30408	Nozzle Z2006 - ø 0,6mm, 25A, O2
	.11.835.221.407	BP-30409	Nozzle Z2007 - ø 0,7mm, 35A, O2
	.11.835.221.408	BP-30410	Nozzle Z2008 - ø 0,8mm, 50A, O2
	.11.835.221.409	BP-30411	Nozzle Z2009 - ø 0,9mm, 70A, O2
	.11.835.221.410	BP-30412	Nozzle Z2010 - ø 1,0mm, 80A, O2
	.11.835.221.411	BP-30413	Nozzle Z2011 - ø 1,1mm, 90A, O2
	.11.835.221.412	BP-30414	Nozzle Z2012 - ø 1,2mm, 100A, O2
05.	.11.835.221.153	BP-30415	Swirl ring Z101 - 3 holes (vespel [®])
06.	.11.835.221.3101AG	BP-30416	Cathode Z002 - XL O2 SILVER
07.	.11.835.201.162	BP-30417	Retaining cap Z3008 - ø 0,8mm
08.	.11.835.421.412	BP-30418	Nozzle Z2112 - ø 1,2mm, 100A, O2
	.11.835.421.414	BP-30419	Nozzle Z2114 - ø 1,4mm, 130A, O2
09.	.11.834.321.153	BP-30208	Swirl ring Z111 (vespel [®])
10.	.11.835.421.303	BP-30420	Spacer ring Z111A (vespel [®])
11.	.11.835.421.3101AG	BP-30421	Cathode Z012 - XL O2 SILVER
12.	.11.835.201.152	BP-30422	Cooling tube - PerCut 101
13.	.10.575.052	BP-30109	"O" - ring 20x2 silicone
14.	.10.505.946	BP-30423	"O" - ring 36x2 silicone



KJELLBERG[®]

Plasma system: **HiFocus 130[®]**

Torch: **PerCut 160/170[®]**

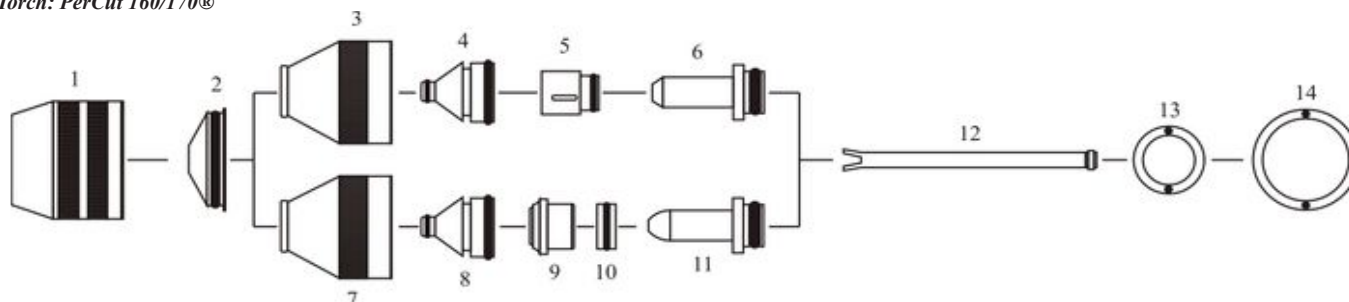

ITEM	REF. NUMBER	ORDER NUMBER	DESCRIPTION
01.	.11.835.201.081	BP-30401	Shield cap Z501
02.	.11.835.201.1561	BP-30402	Shield Z4015 - ø 1,5mm
	.11.835.201.1571	BP-30403	Shield Z4020 - ø 2,0mm
	.11.835.201.1551	BP-30501	Shield Z4022 - ø 2,2mm
	.11.835.201.1581	BP-30404	Shield Z4025 - ø 2,5mm
	.11.835.201.1591	BP-30405	Shield Z4030 - ø 3,0mm
	.11.835.401.1571	BP-30406	Shield Z4140 - ø 4,0mm
03.	.11.842.401.160	BP-30502	Retaining cap S3004 - ø 0,4mm
04.	.11.843.021.406	BP-30503	Nozzle S2006X - ø 0,6mm, 25A, O2
	.11.843.021.407	BP-30504	Nozzle S2007X - ø 0,7mm, 35A, O2
	.11.843.021.408	BP-30505	Nozzle S2008X - ø 0,8mm, 50A, O2
	.11.843.021.409	BP-30506	Nozzle S2009X - ø 0,9mm, 70A, O2
	.11.843.021.410	BP-30507	Nozzle S2010X - ø 1,0mm, 80A, O2
	.11.843.021.411	BP-30508	Nozzle S2011X - ø 1,1mm, 90A, O2
	.11.843.021.412	BP-30509	Nozzle S2012X - ø 1,2mm, 100A, O2
	.11.843.021.414	BP-30510	Nozzle S2014X - ø 1,4mm, 130A, O2
05.	.11.835.221.153	BP-30415	Swirl ring Z101 - 3 holes (vespel [®])
	.11.835.221.154	BP-30512	Swirl ring Z102 - 2 holes (vespel [®])
06.	.11.843.021.310AG	BP-30513	Cathode S002X-XL O2 SILVER
	.11.843.021.320AG	BP-30701	Cathode S002Y-XL O2 SILVER
07.	.11.842.401.162	BP-30514	Retaining cap S3008 - ø 0,8mm
	.11.842.401.1622	BP-30515	Retaining cap S3028 - ø 0,8mm
08.	.11.843.121.412	BP-30516	Nozzle S2112X - ø 1,2mm, 100A, O2
	.11.843.121.414	BP-30517	Nozzle S2114X - ø 1,4mm, 130A, O2
09.	.11.834.321.153	BP-30208	Swirl ring Z111 - (vespel [®])
10.	.11.835.421.303	BP-30420	Spacer ring Z111A (vespel [®])
11.	.11.843.121.310AG	BP-30519	Cathode S012X-XL O2 SILVER
12.	.11.842.401.152	BP-30520	Cooling tube - PerCut 160/170
13.	.10.575.052	BP-30109	"O" - ring 20x2 silicone
14.	.10.505.946	BP-30423	"O" - ring 36x2 silicone

KJELLBERG[®], HiFocus 130[®] are the Registered Trademarks of KJELLBERG[®]. B&BARTONI, spol. s r.o. is in no way affiliated with KJELLBERG[®]. The parts advertised for sale are not genuine KJELLBERG[®] parts, but are parts made for and by B&BARTONI, spol. s r.o. Reference to KJELLBERG[®] machine, torches and numbers are for your convenience only. We reserve the right to substitute genuine KJELLBERG[®] parts in place of B&BARTONI, spol. s r.o. parts. Parts indicated with a "OEM" are original parts manufactured by the above named manufacturer and are being resold by B&BARTONI, spol. s r.o..

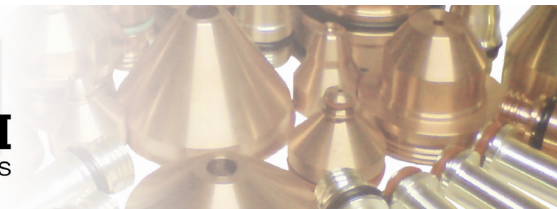

KJELLBERG[®]

Plasma system: *HiFocus 160i-161i[®]*

Torch: *PerCut 160/170[®]*

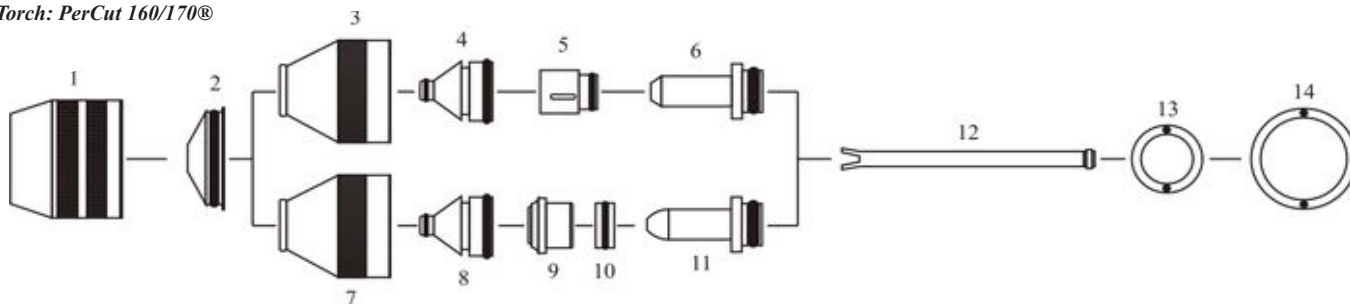

ITEM	REF. NUMBER	ORDER NUMBER	DESCRIPTION
01.	.11.835.201.081	BP-30401	Shield cap Z501
02.	.11.835.201.1561	BP-30402	Shield Z4015 - ø 1,5mm
	.11.835.201.1571	BP-30403	Shield Z4020 - ø 2,0mm
	.11.835.201.1551	BP-30501	Shield Z4022 - ø 2,2mm
	.11.835.201.1581	BP-30404	Shield Z4025 - ø 2,5mm
	.11.835.201.1591	BP-30405	Shield Z4030 - ø 3,0mm
	.11.835.401.1571	BP-30406	Shield Z4140 - ø 4,0mm
03.	.11.842.401.160	BP-30502	Retaining cap S3004 - ø 0,4mm
04.	.11.843.021.406	BP-30503	Nozzle S2006X - ø 0,6mm, 25A, O2
	.11.843.021.407	BP-30504	Nozzle S2007X - ø 0,7mm, 35A, O2
	.11.843.021.408	BP-30505	Nozzle S2008X - ø 0,8mm, 50A, O2
	.11.843.021.409	BP-30506	Nozzle S2009X - ø 0,9mm, 70A, O2
	.11.843.021.410	BP-30507	Nozzle S2010X - ø 1,0mm, 80A, O2
	.11.843.021.411	BP-30508	Nozzle S2011X - ø 1,1mm, 90A, O2
	.11.843.021.412	BP-30509	Nozzle S2012X - ø 1,2mm, 100A, O2
	.11.843.021.414	BP-30510	Nozzle S2014X - ø 1,4mm, 130A, O2
	.11.843.021.416	BP-30511	Nozzle S2016X - ø 1,6mm, 160A, O2
05.	.11.835.221.153	BP-30415	Swirl ring Z101 - 3 holes (vespel [®])
	.11.835.221.154	BP-30512	Swirl ring Z102 - 2 holes (vespel [®])
06.	.11.843.021.310AG	BP-30513	Cathode S002X-XL O2 SILVER
	.11.843.021.320AG	BP-30701	Cathode S002Y-XL O2 SILVER
07.	.11.842.401.162	BP-30514	Retaining cap S3008 - ø 0,8mm
	.11.842.401.1622	BP-30515	Retaining cap S3028 - ø 0,8mm
08.	.11.843.121.412	BP-30516	Nozzle S2112X - ø 1,2mm, 100A, O2
	.11.843.121.414	BP-30517	Nozzle S2114X - ø 1,4mm, 130A, O2
	.11.843.121.416	BP-30518	Nozzle S2116X - ø 1,6mm, 160A, O2
09.	.11.834.321.153	BP-30208	Swirl ring Z111 - (vespel [®])
10.	.11.835.421.303	BP-30420	Spacer ring Z111A (vespel [®])
11.	.11.843.121.310AG	BP-30519	Cathode S012X-XL O2 SILVER
12.	.11.842.401.152	BP-30520	Cooling tube - PerCut 160/170
13.	.10.575.052	BP-30109	"O" - ring 20x2 silicone
14.	.10.505.946	BP-30423	"O" - ring 36x2 silicone

KJELLBERG[®], HiFocus 160[®] are the Registered Trademarks of KJELLBERG[®]. B&BARTONI, spol. s r.o. is in no way affiliated with KJELLBERG[®]. The parts advertised for sale are not genuine KJELLBERG[®] parts, but are parts made for and by B&BARTONI, spol. s r.o.. Reference to KJELLBERG[®] machine, torches and numbers are for your convenience only. We reserve the right to substitute genuine KJELLBERG[®] parts in place of B&BARTONI, spol. s r.o. parts. Parts indicated with a "OEM" are original parts manufactured by the above named manufacturer and are being resold by B&BARTONI, spol. s r.o..



KJELLBERG[®]

Plasma system: **HiFocus 160i (3D)[®]**

Torch: **PerCut 160/170 (3D)[®]**

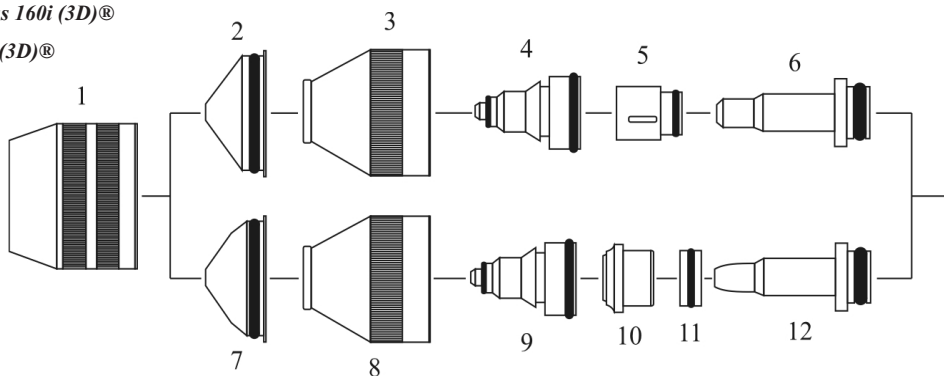

ITEM	REF. NUMBER	ORDER NUMBER	DESCRIPTION
01.	.11.835.201.081	BP-30401	Shield cap Z501
02.	.11.838.001.1561	BP-30601	Shield Y4015 - ø 1,5mm
	.11.838.001.1571	BP-30602	Shield Y4020 - ø 2,0mm
	.11.842.601.157	BP-30603	Shield R4020 - ø 2,0mm
	.11.842.601.155	BP-30604	Shield R4022 - ø 2,2mm
	.11.842.601.158	BP-30605	Shield R4025 - ø 2,5mm
03.	.11.842.601.160	BP-30606	Retaining cap R3004 - ø 0,4mm "OEM"
04.	.11.842.621.406	BP-30607	Nozzle R2006 - ø 0,6mm, 25A (3D)
	.11.842.621.407	BP-30608	Nozzle R2007 - ø 0,7mm, 35A (3D)
	.11.842.621.408	BP-30609	Nozzle R2008 - ø 0,8mm, 50A (3D)
	.11.842.621.409	BP-30610	Nozzle R2009 - ø 0,9mm, 70A (3D)
	.11.842.621.410	BP-30611	Nozzle R2010 - ø 1,0mm, 80A (3D)
	.11.842.621.411	BP-30612	Nozzle R2011 - ø 1,1mm, 90A (3D)
	.11.842.621.412	BP-30613	Nozzle R2012 - ø 1,2mm, 100A (3D)
	.11.842.621.414	BP-30614	Nozzle R2014 - ø 1,4mm, 130A (3D)
	.11.842.621.416	BP-30615	Nozzle R2016 - ø 1,6mm, 160A (3D)
05.	.11.835.221.153	BP-30415	Swirl ring Z101 - 3 holes (vespel [®])
	.11.835.221.154	BP-30512	Swirl ring Z102 - 2 holes (vespel [®])
06.	.11.842.621.310AG	BP-30616	Cathode R002-XL O2 SILVER (3D)
07.	.11.842.701.158	BP-30617	Shield R4130 - ø 3,0mm (3D)
	.11.842.701.159	BP-30618	Shield R4140 - ø 4,0mm (3D)
08.	.11.842.601.162	BP-30619	Retaining cap R3008 - ø 0,8mm (3D) "OEM"
	.11.842.601.1621	BP-30626	Retaining cap R3018 - ø 0,8mm (3D) "OEM"
	.11.842.601.1622	BP-30620	Retaining cap R3028 - ø 0,8mm (3D) "OEM"
09.	.11.842.721.412	BP-30621	Nozzle R2112 - ø 1,2mm, 100A (3D)
	.11.842.721.414	BP-30622	Nozzle R2114 - ø 1,4mm, 130A (3D)
	.11.842.721.416	BP-30623	Nozzle R2116 - ø 1,6mm, 160A (3D)
10.	.11.834.321.153	BP-30208	Swirl ring Z111 (vespel [®])
11.	.11.835.421.303	BP-30420	Spacer ring Z111A (vespel [®])
12.	.11.842.721.310AG	BP-30624	Cathode R012-XL O2 SILVER (3D)



KJELLBERG[®]

Plasma system: *HiFocus 280i-360i-440i[®]*

Torch: *PerCut 370.1M* - cutting up to 160A

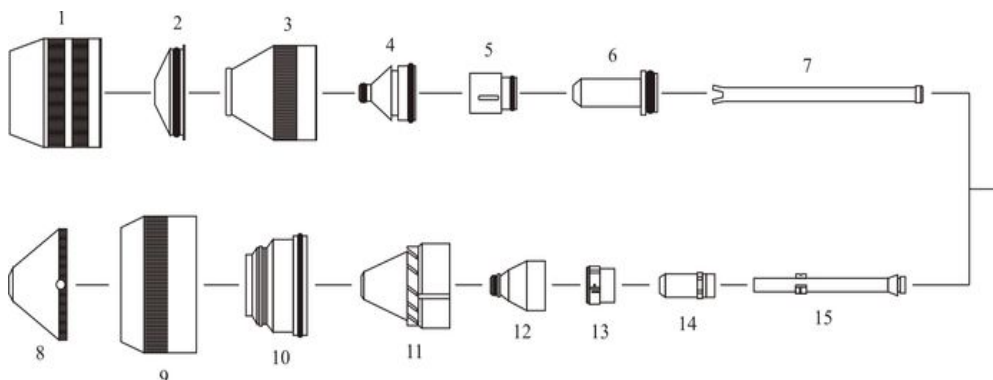

ITEM	REF. NUMBER	ORDER NUMBER	DESCRIPTION
01.	.11.835.201.081	BP-30401	Shield cap Z501
02.	.11.835.201.1561	BP-30402	Shield Z4015 - ø 1,5mm
	.11.835.201.1571	BP-30403	Shield Z4020 - ø 2,0mm
	.11.835.201.1551	BP-30501	Shield Z4022 - ø 2,2mm
	.11.835.201.1581	BP-30404	Shield Z4025 - ø 2,5mm
	.11.835.201.1591	BP-30405	Shield Z4030 - ø 3,0mm
	.11.835.401.1571	BP-30406	Shield Z4140 - ø 4,0mm
03.	.11.842.401.160	BP-30502	Retaining cap S3004 - ø 0,4mm
	.11.842.401.162	BP-30514	Retaining cap S3008 - ø 0,8mm
	.11.842.401.1622	BP-30515	Retaining cap S3028 - ø 0,8mm
04.	.11.843.021.406	BP-30503	Nozzle S2006X - ø 0,6mm, 25A, O2
	.11.843.021.407	BP-30504	Nozzle S2007X - ø 0,7mm, 35A, O2
	.11.843.021.408	BP-30505	Nozzle S2008X - ø 0,8mm, 50A, O2
	.11.843.021.409	BP-30506	Nozzle S2009X - ø 0,9mm, 70A, O2
	.11.843.021.410	BP-30507	Nozzle S2010X - ø 1,0mm, 80A, O2
	.11.843.021.411	BP-30508	Nozzle S2011X - ø 1,1mm, 90A, O2
	.11.843.021.412	BP-30509	Nozzle S2012X - ø 1,2mm, 100A, O2
	.11.843.021.414	BP-30510	Nozzle S2014X - ø 1,4mm, 130A, O2
	.11.843.021.416	BP-30511	Nozzle S2016X - ø 1,6mm, 160A, O2
05.	.11.835.221.153	BP-30415	Swirl ring Z101 - 3 holes (vespel [®])
	.11.835.221.154	BP-30512	Swirl ring Z102 - 2 holes (vespel [®])
06.	.11.843.021.310AG	BP-30513	Cathode S002X-XL O2 SILVER
	.11.843.021.320AG	BP-30701	Cathode S002Y-XL O2 SILVER
07.	.11.842.401.152	BP-30520	Cooling tube - PerCut 160/170



KJELLBERG[®]

Plasma system: *HiFocus 280i-360i-440i[®]*

Torch: *PerCut 370.2M - cutting up to 440A*

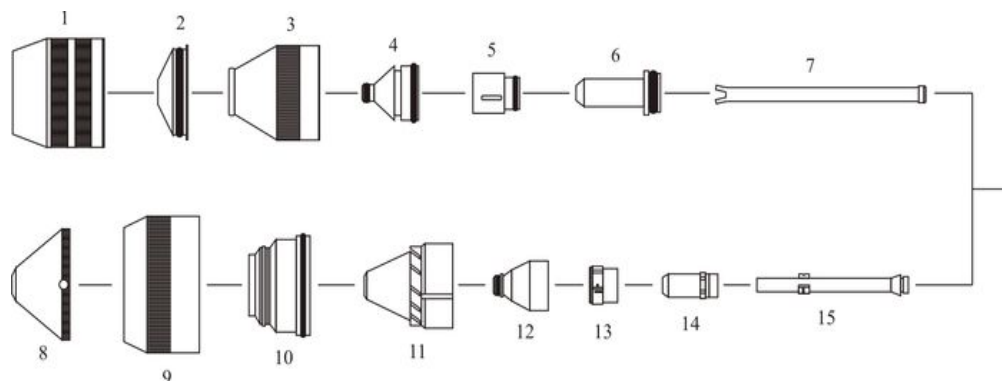

ITEM	REF. NUMBER	ORDER NUMBER	DESCRIPTION
08.	.11.833.101.150	BP-30702	Shield V4330 - ø 3,0mm (dry cutting)
	.11.833.101.155	BP-30703	Shield V4335 - ø 3,5mm (dry cutting)
	.11.833.101.156	BP-30704	Shield V4340 - ø 4,0mm (dry cutting)
	.11.833.101.157	BP-30705	Shield V4345 - ø 4,5mm (dry cutting)
	.11.833.101.158	BP-30706	Shield V4350 - ø 5,0mm (dry cutting)
	.11.833.101.159	BP-30707	Shield V4360 - ø 6,0mm (dry cutting)
09.	.11.841.721.081	BP-30708	Protective cap T502 "OEM"
10.	.11.836.901.271	BP-30709	Swirl gas nozzle T521 "OEM"
	.11.836.921.271	BP-30710	Swirl gas nozzle T522 "OEM"
11.	.11.836.901.163	BP-30711	Retaining cap T3030 - 30 CW
	.11.836.901.164	BP-30712	Retaining cap T3045 - 45 CW
	.11.836.901.1641	BP-30713	Retaining cap T3145 - 45 CCW
	.11.836.901.165	BP-30714	Retaining cap T3060 - 60 CW
	.11.836.901.1651	BP-30715	Retaining cap T3160 - 60 CCW
12.	.11.836.921.415	BP-30716	Nozzle T2115 - ø 1,5mm, 120A, O2
	.11.836.921.420	BP-30717	Nozzle T2120 - ø 2,0mm, 200A, O2
	.11.836.921.425	BP-30718	Nozzle T2125 - ø 2,5mm, 250A, O2
	.11.836.921.427	BP-30719	Nozzle T2127 - ø 2,7mm, 300A, O2
	.11.836.921.430	BP-30720	Nozzle T2130 - ø 3,0mm, 350A, O2
13.	.11.836.921.153	BP-30721	Swirl ring T101 - (6x0,8 CW) / (teflon [®])
	.11.836.921.154	BP-30722	Swirl ring T102 - (3x0,6 CW) / (teflon [®])
	.11.836.921.1542	BP-30723	Swirl ring T104 - (3x0,4 CW) / (teflon [®])
	.11.836.921.1531	BP-30724	Swirl ring T111 - (6x0,8 CCW) / (teflon [®])
	.11.836.921.1541	BP-30725	Swirl ring T112 - (3x0,6 CCW) / (teflon [®])
14.	.11.836.921.300AG	BP-30726	Cathode T012 O2 SILVER
15.	.11.836.901.152	BP-30727	Cooling tube - T901 "OEM"



KJELLBERG[®]

Plasma system: *HiFocus 280i-360i-440i[®]*

Torch: *PerCut 370.2M* - cutting up to 440A

YellowXLife

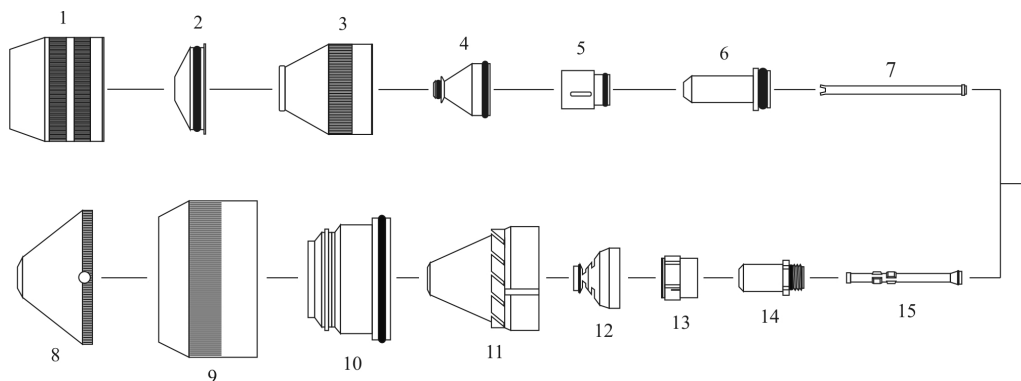

ITEM	REF. NUMBER	ORDER NUMBER	DESCRIPTION
08.	.11.833.101.150	BP-30702	Shield V4330 - ø 3,0mm (dry cutting)
	.11.833.101.155	BP-30703	Shield V4335 - ø 3,5mm (dry cutting)
	.11.833.101.156	BP-30704	Shield V4340 - ø 4,0mm (dry cutting)
	.11.833.101.157	BP-30705	Shield V4345 - ø 4,5mm (dry cutting)
	.11.833.101.158	BP-30706	Shield V4350 - ø 5,0mm (dry cutting)
	.11.833.101.159	BP-30707	Shield V4360 - ø 6,0mm (dry cutting)
09.	.11.841.721.081	BP-30708	Protective cap T502 "OEM"
10.	.11.836.901.271	BP-30709	Swirl gas nozzle T521 "OEM"
	.11.836.921.271	BP-30710	Swirl gas nozzle T522 "OEM"
11.	.11.836.901.163	BP-30711	Retaining cap T3030 - 30 CW
	.11.836.901.164	BP-30712	Retaining cap T3045 - 45 CW
	.11.836.901.1641	BP-30713	Retaining cap T3145 - 45 CCW
	.11.836.901.165	BP-30714	Retaining cap T3060 - 60 CW
	.11.836.901.1651	BP-30715	Retaining cap T3160 - 60 CCW
12.	.11.846.921.415	BP-30729	Nozzle T2115Y - ø 1,5mm, 120A, O2
	.11.846.921.420	BP-30730	Nozzle T2120Y - ø 2,0mm, 200A, O2
	.11.846.921.425	BP-30731	Nozzle T2125Y - ø 2,5mm, 250A, O2
	.11.846.921.427	BP-30732	Nozzle T2127Y - ø 2,7mm, 300A, O2
	.11.846.921.430	BP-30733	Nozzle T2130Y - ø 3,0mm, 360A, O2
13.	.11.836.921.153	BP-30721	Swirl ring T101 - (6x0,8 CW) / (teflon [®])
	.11.836.921.154	BP-30722	Swirl ring T102 - (3x0,6 CW) / (teflon [®])
	.11.836.921.1542	BP-30723	Swirl ring T104 - (3x0,4 CW) / (teflon [®])
	.11.836.921.1531	BP-30724	Swirl ring T111 - (6x0,8 CCW) / (teflon [®])
	.11.836.921.1541	BP-30725	Swirl ring T112 - (3x0,6 CCW) / (teflon [®])
14.	.11.844.921.300AG	BP-30735	Cathode T012Y O2 SILVER
15.	.11.844.901.152	BP-30736	Cooling tube - T902Y "OEM"



KJELLBERG[®]

Plasma system: *FineFocus 800-900-1600[®]*

Torch: *PB-S80 W (dry cutting, underwater cutting)*

PB-S100 WU (underwater cutting)

PB-S151 W (underwater cutting)

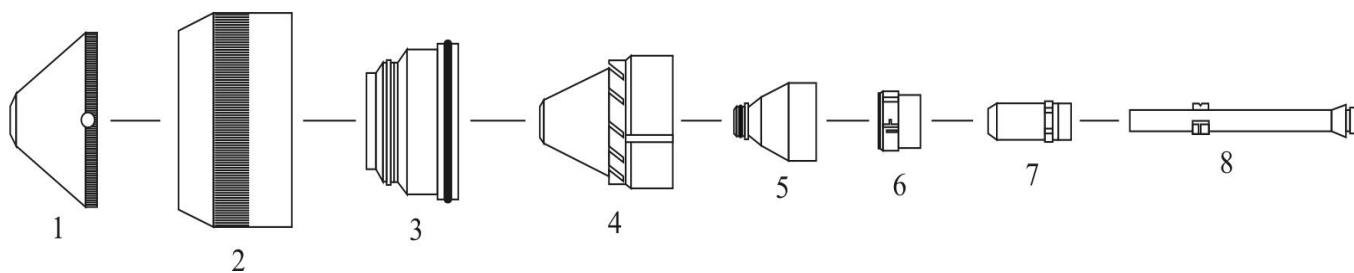

ITEM	REF. NUMBER	ORDER NUMBER	DESCRIPTION
01.	.11.833.101.150	BP-30702	Shield V4330 - ø 3,0mm (dry cutting)
	.11.833.101.155	BP-30703	Shield V4335 - ø 3,5mm (dry cutting)
	.11.833.101.156	BP-30704	Shield V4340 - ø 4,0mm (dry cutting)
	.11.833.101.157	BP-30705	Shield V4345 - ø 4,5mm (dry cutting)
	.11.833.101.158	BP-30706	Shield V4350 - ø 5,0mm (dry cutting)
	.11.833.101.159	BP-30707	Shield V4360 - ø 6,0mm (dry cutting)
02.	.11.841.721.081	BP-30708	Protective cap T502 "OEM"
03.	.11.836.901.271	BP-30709	Swirl gas nozzle T521 "OEM"
	.11.836.921.271	BP-30710	Swirl gas nozzle T522 "OEM"
04.	.11.836.901.163	BP-30711	Retaining cap T3030 - 30 CW
	.11.836.901.164	BP-30712	Retaining cap T3045 - 45 CW
	.11.836.901.1641	BP-30713	Retaining cap T3145 - 45 CCW
	.11.836.901.165	BP-30714	Retaining cap T3060 - 60 CW
	.11.836.901.1651	BP-30715	Retaining cap T3160 - 60 CCW
05.	.11.836.921.415	BP-30716	Nozzle T2115 - ø 1,5mm, 120A, O2
	.11.836.921.420	BP-30717	Nozzle T2120 - ø 2,0mm, 200A, O2
	.11.836.921.425	BP-30718	Nozzle T2125 - ø 2,5mm, 250A, O2
	.11.836.921.427	BP-30719	Nozzle T2127 - ø 2,7mm, 300A, O2
	.11.836.921.430	BP-30720	Nozzle T2130 - ø 3,0mm, 350A, O2
06.	.11.836.921.153	BP-30721	Swirl ring T101 - (6x0,8 CW) / (teflon [®])
	.11.836.921.154	BP-30722	Swirl ring T102 - (3x0,6 CW) / (teflon [®])
	.11.836.921.1542	BP-30723	Swirl ring T104 - (3x0,4 CW) / (teflon [®])
	.11.836.921.1531	BP-30724	Swirl ring T111 - (6x0,8 CCW) / (teflon [®])
	.11.836.921.1541	BP-30725	Swirl ring T112 - (3x0,6 CCW) / (teflon [®])
07.	.11.836.921.300AG	BP-30726	Cathode T012 O2 SILVER
08.	.11.836.901.152	BP-30727	Cooling tube - T901 "OEM"



KJELLBERG[®]

Plasma system: *FineFocus 800-900-1600[®]*

Torch: *PB-S80 W (dry cutting, underwater cutting)*

PB-S100 WU (underwater cutting)

PB-S151 W (dry cutting)

YellowXLife

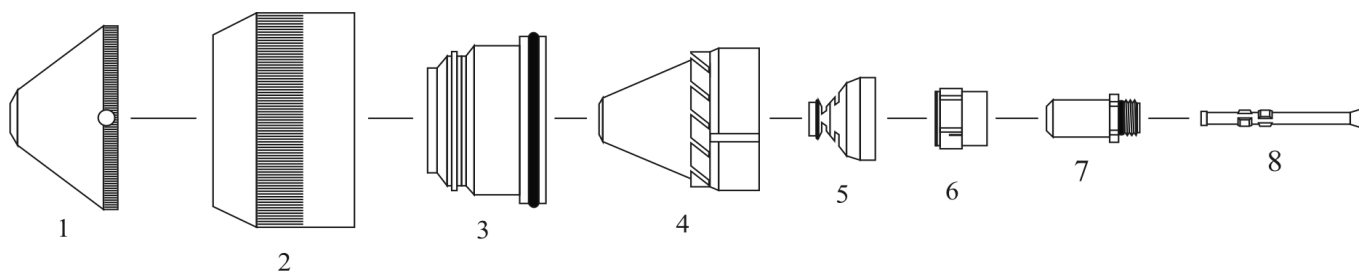

ITEM	REF. NUMBER	ORDER NUMBER	DESCRIPTION
01.	.11.833.101.150	BP-30702	Shield V4330 - ø 3,0mm (dry cutting)
	.11.833.101.155	BP-30703	Shield V4335 - ø 3,5mm (dry cutting)
	.11.833.101.156	BP-30704	Shield V4340 - ø 4,0mm (dry cutting)
	.11.833.101.157	BP-30705	Shield V4345 - ø 4,5mm (dry cutting)
	.11.833.101.158	BP-30706	Shield V4350 - ø 5,0mm (dry cutting)
	.11.833.101.159	BP-30707	Shield V4360 - ø 6,0mm (dry cutting)
02.	.11.841.721.081	BP-30708	Protective cap T502 "OEM"
03.	.11.836.901.271	BP-30709	Swirl gas nozzle T521 "OEM"
	.11.836.921.271	BP-30710	Swirl gas nozzle T522 "OEM"
04.	.11.836.901.163	BP-30711	Retaining cap T3030 - 30 CW
	.11.836.901.164	BP-30712	Retaining cap T3045 - 45 CW
	.11.836.901.1641	BP-30713	Retaining cap T3145 - 45 CCW
	.11.836.901.165	BP-30714	Retaining cap T3060 - 60 CW
	.11.836.901.1651	BP-30715	Retaining cap T3160 - 60 CCW
05.	.11.846.921.415	BP-30729	Nozzle T2115Y - ø 1,5mm, 120A, O2
	.11.846.921.420	BP-30730	Nozzle T2120Y - ø 2,0mm, 200A, O2
	.11.846.921.425	BP-30731	Nozzle T2125Y - ø 2,5mm, 250A, O2
	.11.846.921.427	BP-30732	Nozzle T2127Y - ø 2,7mm, 300A, O2
	.11.846.921.430	BP-30733	Nozzle T2130Y - ø 3,0mm, 360A, O2
06.	.11.836.921.153	BP-30721	Swirl ring T101 - (6x0,8 CW) / (teflon [®])
	.11.836.921.154	BP-30722	Swirl ring T102 - (3x0,6 CW) / (teflon [®])
	.11.836.921.1542	BP-30723	Swirl ring T104 - (3x0,4 CW) / (teflon [®])
	.11.836.921.1531	BP-30724	Swirl ring T111 - (6x0,8 CCW) / (teflon [®])
	.11.836.921.1541	BP-30725	Swirl ring T112 - (3x0,6 CCW) / (teflon [®])
07.	.11.844.921.300AG	BP-30735	Cathode T012Y O2 SILVER
08.	.11.844.901.152	BP-30736	Cooling tube - T902Y "OEM"



KJELLBERG[®]

Plasma system: PA-S50-75-76-77-150 W[®]

Torch: PB-S70 W[®]

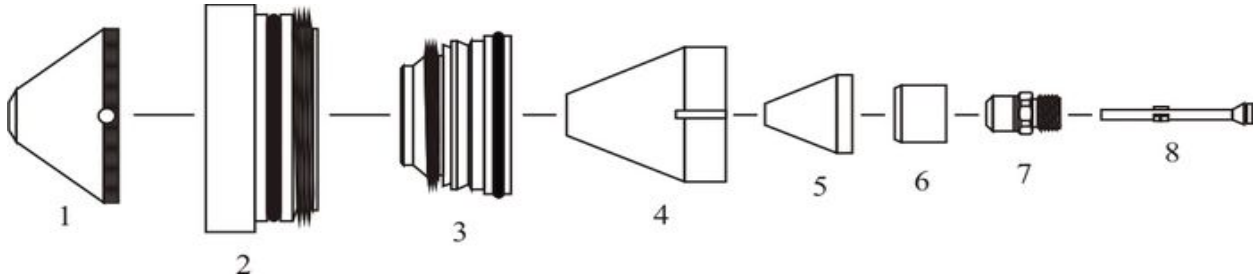

ITEM	REF. NUMBER	ORDER NUMBER	DESCRIPTION
01.	.11.833.101.150	BP-30702	Shield V4330 - ø 3,0mm (dry cutting)
	.11.833.101.155	BP-30703	Shield V4335 - ø 3,5mm (dry cutting)
	.11.833.101.156	BP-30704	Shield V4340 - ø 4,0mm (dry cutting)
	.11.833.101.157	BP-30705	Shield V4345 - ø 4,5mm (dry cutting)
	.11.833.101.158	BP-30706	Shield V4350 - ø 5,0mm (dry cutting)
	.11.833.101.159	BP-30707	Shield V4360 - ø 6,0mm (dry cutting)
02.	.11.833.101.261	BP-30801	Protective cap V501 "OEM"
	.11.828.401.265	BP-30802	Protective cap "OEM"
03.	.11.833.101.271	BP-30803	Swirl gas nozzle V521
	.11.828.401.275	BP-30804	Swirl gas nozzle "OEM"
04.	.12.37790	BP-30805	Shield cap - ø 38mm
05.	.11.828.501.414	BP-30806	Nozzle L3 - ø 1,4mm, 120A, Air
	.12.43050	BP-30807	Nozzle L1 - ø 2,0mm, 160A, Air
	.12.40850	BP-30808	Nozzle L2 - ø 2,5mm, 250A, Air
	.11.828.501.427	BP-30809	Nozzle L4 - ø 2,7mm, 300A, Air
	.11.828.901.414	BP-30810	Nozzle L3-XL - ø 1,4mm, 120A, O2
	.11.828.901.420	BP-30811	Nozzle L1-XL - ø 2,0mm, 160A, O2
	.11.828.901.425	BP-30812	Nozzle L2-XL - ø 2,5mm, 250A, O2
	.11.828.901.427	BP-30813	Nozzle L4-XL - ø 2,7mm, 300A, O2
06.	.12.40860	BP-30814	Swirl ring / (teflon [®])
07.	.12.40870	BP-30815	Cathode K2 Air
	.11.828.921.300AG	BP-30816	Cathode K2-XL O2 SILVER
	.11.833.121.300AG	BP-30817	Cathode K3-XL O2 SILVER
08.	.12.51440	BP-30818	Cooling tube - PB-S50-75-76-77-150 "OEM"
	.11.836.901.152	BP-30727	Cooling tube - T901 "OEM"



KJELLBERG[®]

Plasma system: PA-S50-75-76-77-150 W[®]

Torch: PB-S70 W[®]

YellowXLife

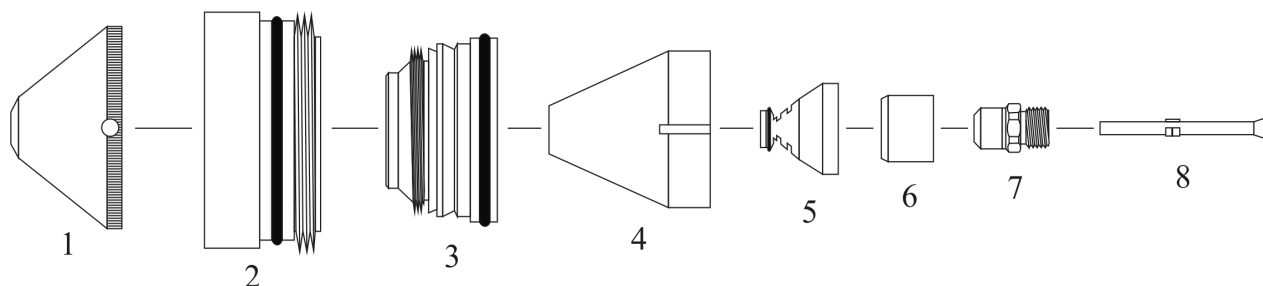

ITEM	REF. NUMBER	ORDER NUMBER	DESCRIPTION
01.	.11.833.101.150	BP-30702	Shield V4330 - ø 3,0mm (dry cutting)
	.11.833.101.155	BP-30703	Shield V4335 - ø 3,5mm (dry cutting)
	.11.833.101.156	BP-30704	Shield V4340 - ø 4,0mm (dry cutting)
	.11.833.101.157	BP-30705	Shield V4345 - ø 4,5mm (dry cutting)
	.11.833.101.158	BP-30706	Shield V4350 - ø 5,0mm (dry cutting)
	.11.833.101.159	BP-30707	Shield V4360 - ø 6,0mm (dry cutting)
02.	.11.833.101.261	BP-30801	Protective cap V501 "OEM"
	.11.828.401.265	BP-30802	Protective cap "OEM"
03.	.11.833.101.271	BP-30803	Swirl gas nozzle V521
	.11.828.401.275	BP-30804	Swirl gas nozzle "OEM"
04.	.11.831.801.160	BP-30819	Shield cap L3000 - ø 38mm
05.	.11.831.821.414	BP-30820	Nozzle L2114Y - ø 1,4mm, 120A, Air
	.11.831.821.420	BP-30821	Nozzle L2120Y - ø 2,0mm, 160A, Air
	.11.831.821.425	BP-30822	Nozzle L2125Y - ø 2,5mm, 250A, Air
	.11.831.821.427	BP-30823	Nozzle L2127Y - ø 2,7mm, 300A, Air
06.	.12.40860	BP-30814	Swirl ring / (teflon [®])
07.	.11.831.801.300AG	BP-30826	Cathode L012Y O2 SILVER
08.	.11.831.801.152	BP-30827	Cooling tube - L901Y "OEM"



SAF[®]

Plasma system: **OCP-150[®]**

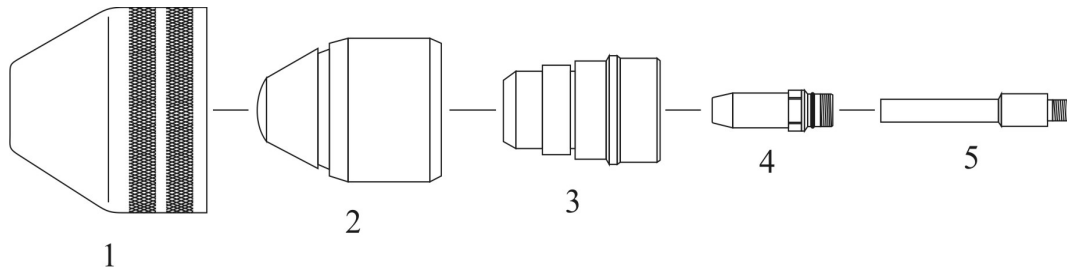

ITEM	REF. NUMBER	ORDER NUMBER	DESCRIPTION
01.	0409-2166	BP-60101	Retaining cap 15A-30A-40A-60A-90A-120A
02.	0409-2171	BP-60102	Nozzle - ø 0,5mm, 15A, O2
	0409-2173	BP-60103	Nozzle - ø 0,7mm, 30A, O2
	0409-2174	BP-60104	Nozzle - ø 0,8mm, 40A, O2
	0409-2176	BP-60105	Nozzle - ø 1,0mm, 60A, O2
	0409-2183	BP-60106	Nozzle - ø 1,3mm, 90A, O2
	0409-2186	BP-60107	Nozzle - ø 1,6mm, 120A, O2
03.	0409-2170	BP-60108	Swirl ring VD6 - 60A
	0409-2169	BP-60109	Swirl ring VD15 - 120A
04.	0409-2185	BP-60111	Electrode 15A-120A, HX5
05.	0409-2154	BP-60112	Cooling tube 15A-30A-40A-60A-90A-120A
N/S	0408-1238	BP-60113	"O"-ring 5,28x1,78 Nitrile
	0408-1282	BP-60114	"O"-ring 36,17x2,62 Nitrile
	0408-1284	BP-60115	"O"-ring 24x2 Nitrile
	0409-1268	BP-60116	"O"-ring 10x3 Silicon



THERMAL DYNAMICS®

Plasma system: **MERLIN 1000-3000-6000 GST®**

Torch: **MAXIMIZER 300®**

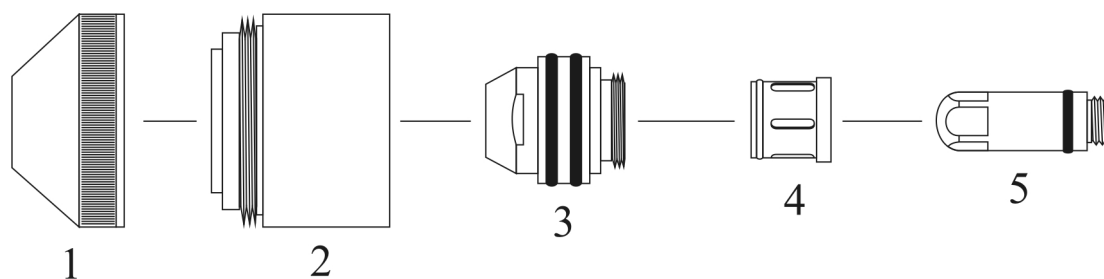

ITEM	REF. NUMBER	ORDER NUMBER	DESCRIPTION
01.	20-1003	BP-50101	Shield 50A
	20-1004	BP-50102	Shield 100A-225A
	20-1005	BP-50201	Shield 300A
02.	20-1002	BP-50103	Retaining cap 50A-300A
03.	20-1030	BP-50104	Nozzle 50A, Air, O2, N2
	20-1031	BP-50105	Nozzle 100A, Air, O2, N2
	20-1032	BP-50202	Nozzle 150A, Air, O2, N2
	20-1033	BP-50203	Nozzle 225A, Air, O2, N2
	20-1034	BP-50204	Nozzle 300A, Air, O2, N2
04.	20-1008	BP-50106	Swirl ring 50A-225A
	20-1009	BP-50205	Swirl ring 300A
05.	20-1018	BP-50108	Electrode 50A-225A, Air
	20-1021	BP-50208	Electrode 300A, Air, O2



B & B[®]
BARTONI
CUTTING CONSUMABLES



THERMAL DYNAMICS[®]

Plasma system: CutMaster 39-52-82-102-152[®]

Torch: SL60-100[®]

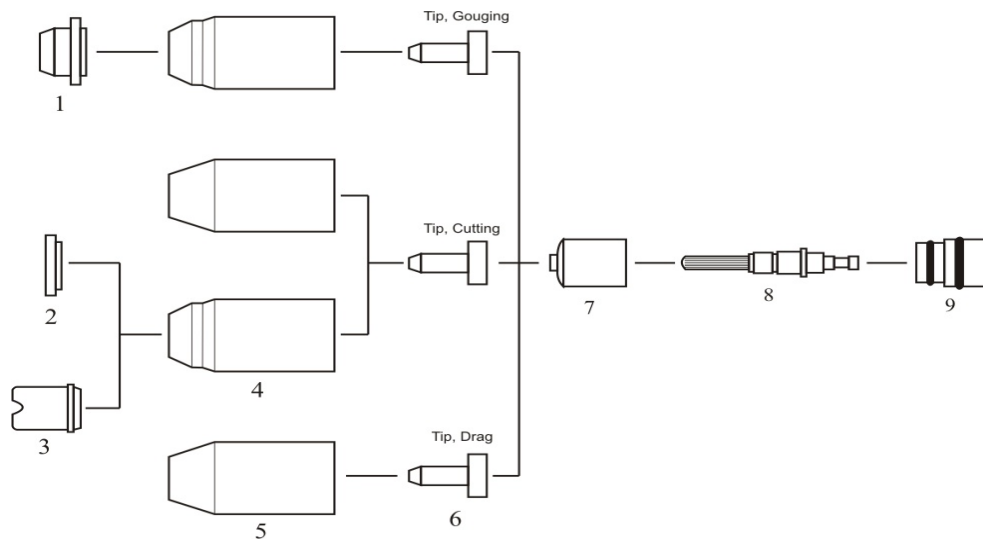

THERMAL DYNAMICS[®], SL60-100[®] are the Registered Trademarks of THERMAL DYNAMICS[®]. B&BARTONI, spol. s r.o. is in no way affiliated with THERMAL DYNAMICS[®]. The parts advertised for sale are not genuine THERMAL DYNAMICS[®] parts, but are parts made for and by B&BARTONI, spol. s r.o.. Reference to THERMAL DYNAMICS[®] machine, torches and numbers are for your convenience only. We reserve the right to substitute genuine THERMAL DYNAMICS[®] parts in place of B&BARTONI, spol. s r.o. parts. Parts indicated with a "OEM" are original parts manufactured by the above named manufacturer and are being resold by B&BARTONI, spol. s r.o..

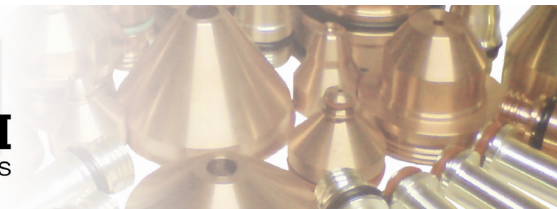

THERMAL DYNAMICS®

Plasma system: CutMaster 39-52-82-102-152®

Torch: SL60-100®

ITEM	REF. NUMBER	ORDER NUMBER	DESCRIPTION
01.	9-8241	BP-50301	Shield - 40A-120A gouging
02.	9-8243	BP-50302	Shield - 40A-120A cutting
03.	9-8244	BP-50303	Shield - 40A cutting (Drag)
	9-8235	BP-50304	Shield - 50A-60A cutting (Drag)
	9-8236	BP-50401	Shield - 70A-100A cutting (Drag)
	9-8258	BP-50402	Shield - 120A cutting (Drag)
	9-8245	BP-50320	Shield cap - 40A cutting (Machine)
	9-8238	BP-50321	Shield cap - 50A-60A cutting (Machine)
	9-8239	BP-50410	Shield cap - 70A-100A cutting (Machine)
	9-8256	BP-50411	Shield cap - 120A cutting (Machine)
04.	9-8237	BP-50305	Retaining cap - 20A-120A (MaximumLife) "OEM"
05.	9-8218	BP-50306	Retaining cap - 20A-120A (Standard) "OEM"
06.	9-8205	BP-50307	Nozzle - 20A (Drag)
	9-8206	BP-50308	Nozzle - 30A (Drag)
	9-8207	BP-50309	Nozzle - 40A (Drag)
	9-8252	BP-50310	Nozzle - 60A (Drag)
	9-8208	BP-50311	Nozzle - 40A cutting (Standoff)
	9-8209	BP-50312	Nozzle - 50A-55A cutting (Standoff)
	9-8210	BP-50313	Nozzle - 60A cutting (Standoff)
	9-8231	BP-50403	Nozzle - 70A cutting (Standoff)
	9-8211	BP-50404	Nozzle - 80A cutting (Standoff)
	9-8212	BP-50405	Nozzle - 90A-100A cutting (Standoff)
	9-8253	BP-50406	Nozzle - 120A cutting (Standoff)
	9-8225	BP-50314	Nozzle - 40A gouging "A"
	9-8226	BP-50315	Nozzle - 60A gouging "B"
	9-8227	BP-50407	Nozzle - 80A gouging "C"
	9-8228	BP-50408	Nozzle - 100A gouging "D"
	9-8254	BP-50409	Nozzle - 120A gouging "E"
07.	9-8213	BP-50316	Swirl ring - 20A-120A "OEM"
08.	9-8215	BP-50317	Electrode - 20A-120A (MaximumLife)
09.	9-3486	BP-50318	O - ring
	9-3487	BP-50319	O - ring



This image shows a single sheet of white paper with horizontal ruling lines. The lines are evenly spaced and run across the width of the page. There are no margins, text, or other markings on the paper.